

## *Chris-Craft* 1969 27' Commander

This handsome cruiser accommodates four in comfort, comes ready to cruise with an impressive list of standard equipment usually offered as optional on a boat this size. Examples: drapes, bilge blower, helmsman and companion seats, and 115V AC wiring for shore hook-up. See other items on back page. She's as impressive in her performance as she is in her cruising comforts: 38 MPH with twin 200-HP V-8's, also offered with single 230-HP.



# Chris-Craft® 1969 27' COMMANDER

## STANDARD EQUIPMENT

- Anchor and Nylon Line
- Battery Disconnect Switches
- Bilge Blower
- Bow Pole and Pennant
- Carpeting
- Chocks and Cleats
- Cockpit Paneling
- Cockpit Rail
- Convertible Dinette
- Deck Hatch, forward
- Dock Lines, nylon
- Dockside Wiring 115V AC 30 amp 3 wire inlet with shore cable, adapter and 3-wire cabin outlets
- Draperies
- Electric Bilge Pump, automatic
- Electric Horn
- Fire Extinguishers
- Foam Cushions and Mattresses
- Fog Bell
- Cold Water Pressure System
- Galley with Alcohol Stove, Ice Box, Sink
- Handrails on cabin top
- Helmsman and Companion Seats with folding footrest
- International Navigation Lights
- Life Preservers
- Mast with Anchor Light
- Mirror in Lavatory
- Muffler
- Screens
- Shipping Cradle
- Stern Pole and Ensign
- Toilet, manual
- Ventilating Windshield
- Windshield Wiper
- PHP

## MORE THAN \$1,100 IN EQUIPMENT ADDED AS STANDARD ON 1969 MODEL\*

- Anchor and Nylon Line
- Bilge Blower
- Dockside Wiring 115V AC 30 amp 3-wire inlet with shore cable, adapter and 3-wire cabin outlets
- Draperies
- Electric Bilge Pump, automatic
- Fresh Water Pressure System
- Helmsman and Companion Seats with folding footrest
- Muffler
- Screens
- Windshield Wiper

\* Compared to 1968 model and based on accessory price list of March 1, 1968.

## SPECIFICATIONS

Sleeping Capacity	4
Length	27'0"
Beam	10'3"
Draft (single screw)	25¼"
Draft (twin screw)	22¼"
Freeboard, forward	51¼"
Freeboard, aft	37¼"
Height from waterline (clearance) to top of mast	9'3"
Weight (lbs., estimated)	5,915-7,174
Headroom	6'3"
Fuel Capacity, gallons (single screw)	48
Fuel Capacity, gallons (twin screw)	80
Fresh-water Capacity, gallons	18.5
Forward, Side and Aft Decks	Fiberglass
Cockpit Floor	Fiberglass

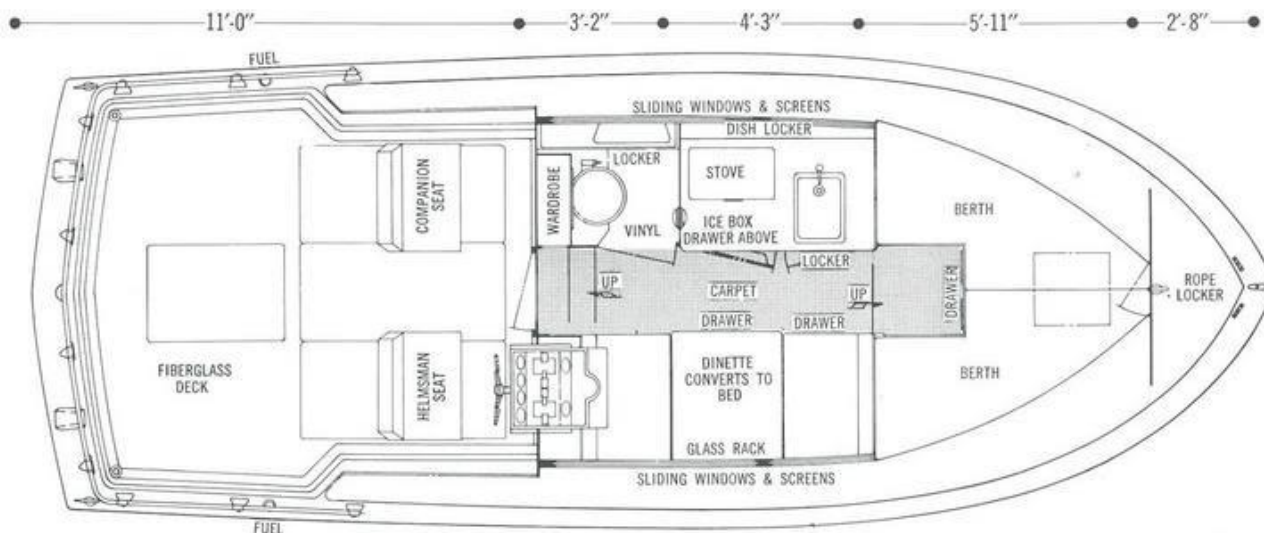

All illustrations and specifications contained in this literature are based on the latest product information available at the time of publication approval. The right is reserved to make changes at any time without notice in prices, colors, materials, equipment, specifications and models, also to discontinue models.

CHRIS-CRAFT DIVISION

Chris-Craft Corporation, Pompano Beach, Florida