

Commander 1969



Chris-Craft

Chris-Craft

FIBERGLASS

38' COMMANDER SEDAN

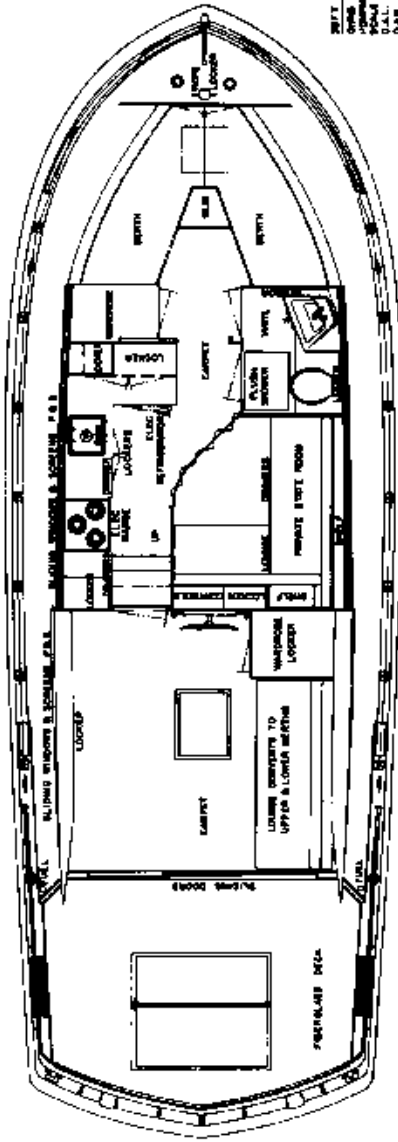
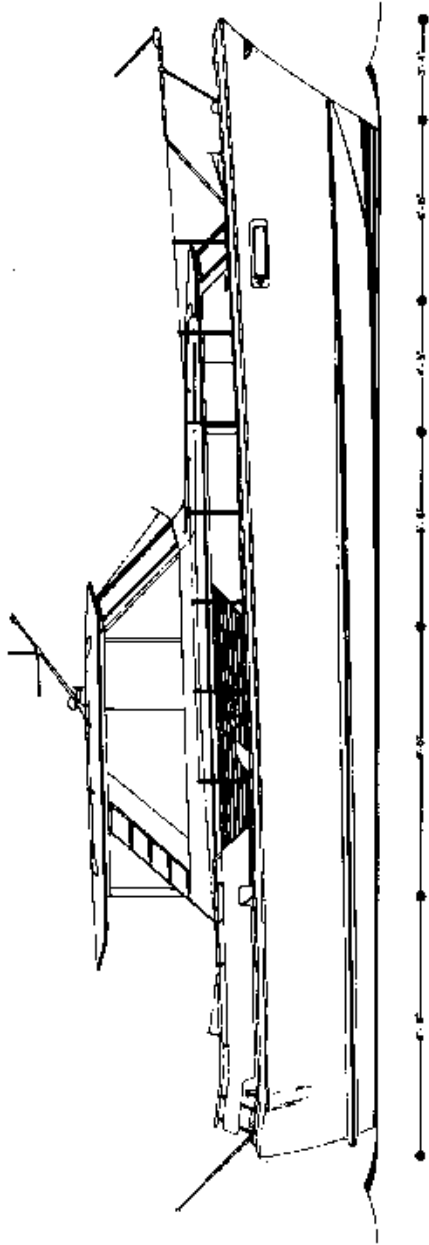

SEE LIST OF STANDARD EQUIPMENT ON PAGE 115 OF THIS CATALOG. EQUIPMENT LISTED IN THIS CATALOG IS SUBJECT TO CHANGE WITHOUT NOTICE. MATERIALS AND COLORS AS SHOWN.

CHRIS CRAFT SALES & SERVICE
 503 CITY ISLAND AVE.
 NEW YORK 64, N. Y.
 TT 3-0980

STANDARD EQUIPMENT

- Anchor • Anchor Line • Automatic Bilge Pump • Bell • Bilge Blower
- Bow Pole and Pennant • Carpeting • Chocks • Cleats • Cockpit
- Drains • Compass • Dock Lines • Draperies • Electric Horn •
- Electric Refrigerator • Electric Stove, 3-burner, w/oven • Electric
- Toilet • Fire Extinguishers • Fresh Water System, Hot and Cold •
- Foam Cushions and Mattresses • Handrails and Stanchions on For-
- ward, Side and Aft Decks • Handrails on Cabin Roof • Hardtop with
- Ventilating Windshields and Sliding Sideshield • Hatch with Dead-
- light and Grille • Helmsman Seat • International Navigation Lights
- Life Preservers • Mast and Yardarm • Mirror • Mooring Bitts •
- Mufflers • Rope Deck Pipe • Screens • Shipping Cradle • Shower
- Stainless-Steel Galley Sink • Stern Pole and Ensign • Weather
- Cloths • Windshield Wiper • Wiring, 115 Volt.

SPECIFICATIONS

| | |
|-------------------------------------|--------------|
| Length O.A. | 38'0" |
| Beam | 13'0" |
| Sleeping Capacity | 6 |
| Draft | 36" |
| Construction | CCFiberglass |
| Fuel Capacity, Gallons | 200 |
| Fresh-Water Capacity, Gallons | 75 |

CHRIS-CRAFT DIVISION
 Chris-Craft Corporation, Pompano Beach, Florida

ALL ILLUSTRATIONS AND SPECIFICATIONS CONTAINED IN THIS LITERATURE ARE BASED ON THE LATEST PRODUCT INFORMATION AVAILABLE AT THE TIME OF PUBLICATION APPROVAL. THE RIGHT IS RESERVED TO MAKE CHANGES AT ANY TIME WITHOUT NOTICE IN PRICES, COLORS, MATERIALS, EQUIPMENT, SPECIFICATIONS AND MODELS, AND ALSO TO DISCONTINUE MODELS.

The proudest of fleets

In order to produce fiberglass boats equal in quality and performance to the other Chris-Craft fleets, it was necessary for Chris-Craft to develop a whole new technology for fiberglass boat-building. New gelcoats and resins with greater resistance to cracking, fading and crazing were produced. New production methods were found. New reinforcing materials such as Sykore and Duo-Glas were developed... and many other innovations came about. And they're still counting about in Chris-Craft's Research and Development Division in Pompano Beach, Florida.

The fruits of the new technology are offered in every model of the 1969 Commander fleet, the proudest ever offered in fiberglass by any builder. The fleet ranges from a sporty new 19-foot Super Sport to the Queen of the Fleet—the 60-foot Commander. Chris-Craft's fiberglass technology played no small part in bringing about this grand lady... and as in the past, Chris-Craft leadership paves the way for others. A new era of fiberglass boats of motor yacht size has begun.

There are other pleasant surprises in store in the 1969 fleet. In many cases Chris-Craft V8 engine power has been increased, promising livelier performance for Commander owners. And a great many items usually considered as extra equipment are now standard equipment aboard the 1969 Commanders, making them even greater values than ever. Like all Chris-Craft products, Commander models are protected by the Chris-Craft Warranty, which extends for two years on parts and one year on labor.

Chris-Craft Cruise Control, standard equipment on some Commander models, optional on others, is a system which lets the pilot adjust trim tabs which are faired into the hull bottom at the stern. Greater speed, fuel economy, and load adjustment can be achieved by moving a pair of switches at the helm. Available with a position indicator (extra).

CHRIS-CRAFT'S TESTING METHODS ASSURE HIGHEST QUALITY FIBERGLASS

Fiberglass gets slammed, shaken, pressed, pulled, bent, scratched, soaked, steamed, and burned in Chris-Craft's Research Center in an effort to build better fiberglass hulls for Chris-Craft Commanders.

When the fiberglass boatbuilding program began, few machines for testing fiberglass existed. So Chris-Craft designed some and adapted other devices built for other purposes. Now a full laboratory of equipment keeps building standards high, and new testing machines

are constantly being developed.

Here are some of the ways that Chris-Craft tests fiberglass:

1. Color-fading tests are carried out in high intensity ultraviolet light Fade-O-Meters at independent testing laboratories. Although accelerated weathering tests are given, the findings are not relied on solely, but are verified with prolonged outdoor exposure tests to natural sunlight and salt-laden humidity. Color fastness and deterioration of gelcoats can be studied this way.
2. Another gelcoat test is given by a machine that strikes a gelcoated fiberglass laminate sample from the layup side. If the front surface cracks or crazes, the gelcoat formula is rejected.
3. Another machine resembles a record player. The arm is weighted and a diamond stylus moves across the gelcoat sample. If the needle-sharp point scratches the gelcoat, it is rejected. At this time, only two gelcoat manufacturers produce gelcoats which meet Chris-Craft's requirements.
4. Fatigue, the weakening which occurs after prolonged flexing, is measured in laminate samples on another Chris-Craft testing machine. If the fiberglass shows no measurable decrease in strength after 1 1/2 million flexing cycles, it is acceptable.
5. Salt Spray Chamber creates hot salt vapor steamier than any tropic swamp, which accelerates the destructive effects of humid, salty air on boats.
6. The burn-out. Pieces taken from through-hull fittings of production boats are weighed, then placed in a 1450° oven where the resin is burned away. The fiberglass reinforcement, which does not burn, is weighed afterwards to determine the ratio of fiberglass to resin.

The more fiberglass contained in the resin, the stronger the laminate. The scales used are accurate to one five-millionth of a pound. Other torture machines compress, pull, and bend fiberglass to find the breaking points. In general, Chris-Craft requires 3 times the strength indicated for a given anticipated load, and certain key points receive reinforcement far exceeding this.

Many boatmen are surprised to learn that an inferior fiberglass laminate may absorb as much as 10% of its weight in water, which can cause as much as 50% loss of strength. In many cases, the sizing used to hold resin and fiberglass together is too absorbent. And sometimes a poor gelcoat is at fault. For this reason, Chris-Craft specifies non-porous

gelcoats, inspected for microscopic pinholes with high-power 3-dimensional microscopes. Chris-Craft also chooses sizings with high resistance to moisture. Present Chris-Craft standards call for laminates with less than 1/10 of 1% of their weight in water absorption, and with not more than a 5% loss of strength. Chris-Craft is thus able to keep well within its own safety factor of 3 or more times anticipated load.

Because of their hardness, gloss, and resistance to crazing, Chris-Craft gelcoats are not painted (except for anti-fouling paint below the waterline). And with proper maintenance, Commander hullides and superstructures should never need painting.

By starting with the very basic elements of fiberglass construction, Chris-Craft is able to improve quality control throughout all the steps in the manufacture of a fiberglass pleasure boat.

EVERY COMMANDER HAS THESE IMPORTANT SAFETY FEATURES

At least two exits from every cruiser cabin Safety glass windshields • At least 4 bilge ventilators, with a minimum of one square inch of opening on each ventilator for each foot of beam (exceeds Coast Guard regulations) Cabintop handrails fastened with bolts, not screws • Fuel tank overflow pipes drain overboard • Special anti-siphoning device keeps fuel from draining out of gasoline tank when fuel line is disconnected • Electric wiring exceeds AIEE standards • Cockpit railings at least 28 inches high • Full visibility from pilot station at planing angles.

WARRANTY

For the first 24 months or 400 hours of operation, whichever comes first, Chris-Craft Corporation will repair or replace, at its option, parts defective by reason of faulty workmanship or material returned to the selling dealer with transportation charges to the point of manufacture. For the first 12 months or 200 hours of operation, whichever comes first, Chris-Craft will pay the labor costs as determined by its schedule for removal and reinstallation of such parts. Chris-Craft does not warrant used boats or engines, coatings, plating, furnishings, metal discoloration, racing boats or engines, altered boats or parts or speeds, and makes no other warranties, express or implied.

Commander 1969

*Chris * Craft **

Chris-Craft® 1969 19' Commander Super Sport

A new design by ocean racing champion Jim Wynne, whose performance is as racy as her appearance: 42 MPH with a 230-HP V-8. A V-drive packs her power at the stern, making possible an exceptionally large cockpit for a boat this length. A three-place stern seat is standard. Twin bucket seats forward and ship-side storage aft.



Chris-Craft • 1969 19' COMMANDER SUPER SPORT

STANDARD EQUIPMENT

- Battery — 12V
- Bilge Pump, manual
- Bucket Seats
- Chocks
- Cockpit Paneling with storage
- Dock Lines, nylon
- Fire Extinguisher
- Electric Horn
- Full Width Upholstered Stern Seat
- Instrumentation including
 - Fuel Gauge
 - Life Preservers
 - Lifting Rings
 - Navigation Lights
 - Shipping Cradle
- Stern Pole and Ensign
- Thru hull drain aft
- Wind Screen Plexiglass

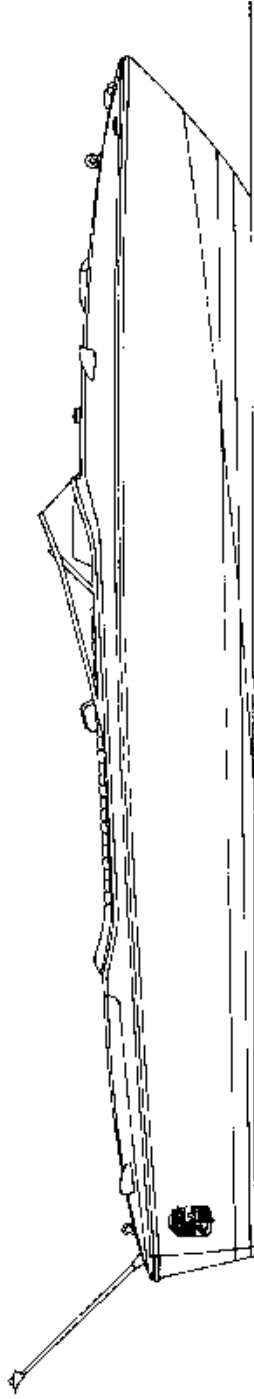

4'-6" 6'-8" 8'-2"

SPECIFICATIONS

| | |
|--------------------------------------|------------------------|
| Seating Capacity | 5 |
| Length | 19'3 3/8" |
| Beam | 7'4 3/8" |
| Draft | 2'5 1/4" |
| Freeboard, forward | 2'0" |
| Freeboard, aft | 1'8" |
| Height from waterline (clearance) | 3'4" |
| Weight (lbs., estimated) | 2,861 |
| Fuel Capacity, gallons | 34 |
| Forward, Side and Aft Decks | Fiberglass |
| Cockpit Floor | Plywood, Vinyl-covered |
| Bottom | Fiberglass |
| Hullsides | Fiberglass |

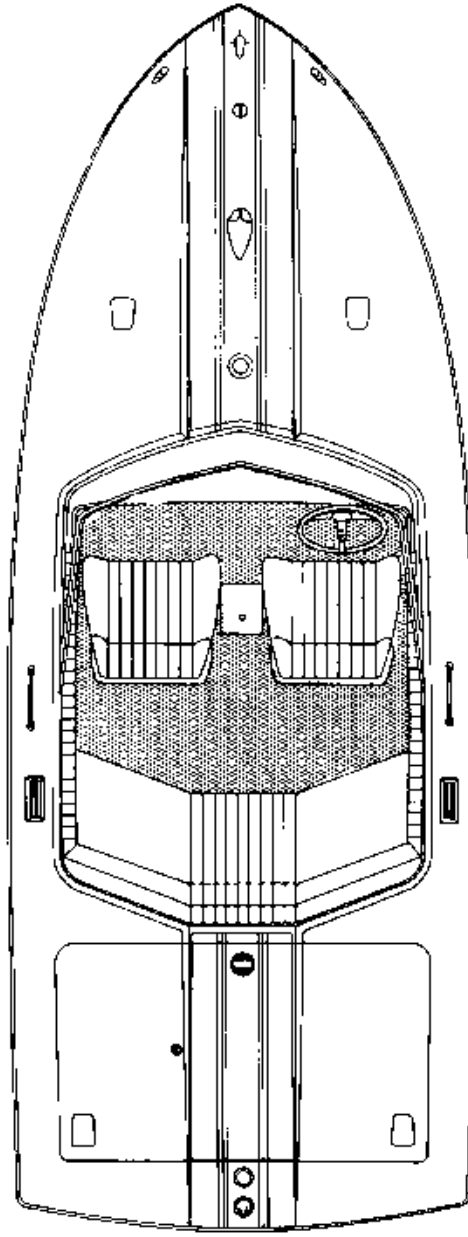

All illustrations and specifications contained in this literature are based on the latest product information available at the time of publication approval. The right is reserved to make changes at any time without notice in prices, colors, materials, equipment, specifications and models, also to discontinue models.

CHRIS-CRAFT DIVISION

Chris-Craft Corporation, Pompano Beach, Florida

Chris-Craft® 1969 23' Commander

This V-drive deep-V, designed by ocean racing champion Jim Wynne, is built for swingers — she sizzles at 42 MPH with a 300-HP V-8 engine. A Chris-Craft 230-HP engine is also available. Pedestal type bucket seats with headrests are standard forward, and a $\frac{3}{4}$ - width lounge seat is optional amidships. The center section of the windshield opens so that you can step into the forepeak to tend lines. A marine toilet is optional, as is a mid-ship ski-tow.

SPECIFICATIONS

| | |
|-----------------------------------|------------------------------|
| Sleeping Capacity (pads extra) | 2 |
| Seating Capacity | Std. 5, opt. 2 additional |
| Length | 23'1" |
| Beam | 8'0" |
| Draft | 30 $\frac{1}{2}$ " |
| Freeboard, forward | 34" |
| Freeboard, aft | 30" |
| Height from waterline (clearance) | 62" |
| Weight (lbs., estimated) | 4,325-4,625 |
| Fuel Capacity, gallons | 50 |
| Forward, Side and Aft Decks | Fiberglass |
| Cockpit Floor | Vinyl-covered Fiberglass |
| Bottom | Fiberglass |
| Hullsides | Fiberglass |



Chris-Craft • 1969 23' COMMANDER

STANDARD EQUIPMENT

- Battery—12V
- Bilge Pump, Electric
- Bucket Seats with Head Rests, Forward
- Cleets
- Cockpit Paneling with Storage
- Dock Lines, nylon
- Fire Extinguisher
- Electric Horn
- Full Width Upholstered Stern Seat
- Instrumentation
- Life Preservers
- Navigation Lights
- Shipping Cradle
- Forward Sliding Deck Hatch
- Stern Pole and Ensign
- Thru hull drain aft
- Vee Berth Platforms
- Ventilating Walk-Thru Windshield

3'-8" 10'-10" 8'-7"

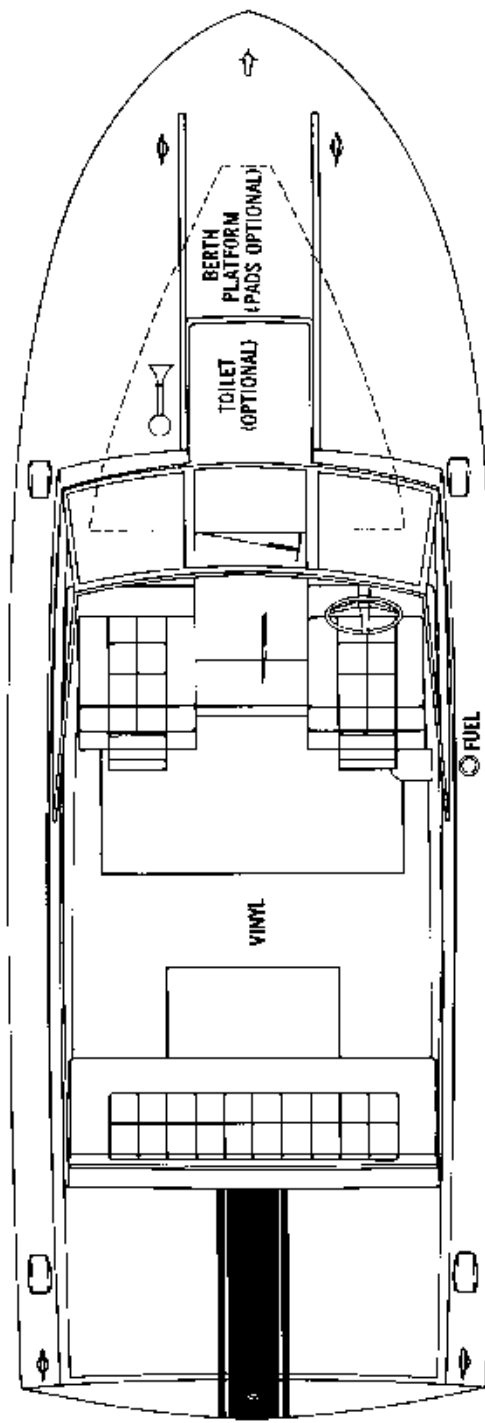

All illustrations and specifications contained in this literature are based on the latest product information available at the time of publication approval. The right is reserved to make changes at any time without notice in prices, colors, materials, equipment, specifications and models, also to discontinue models.

Chris-Craft® 1969 27' Commander

This handsome cruiser accommodates four in comfort, comes ready to cruise with an impressive list of standard equipment usually offered as optional on a boat this size. Examples: drapes, bilge blower, helmman and companion seats, and 115V AC wiring for shore hook-up. See other items on back page. She's as impressive in her performance as she is in her cruising comforts: 38 MPH with twin 200-HP V-8's, also offered with single 230-HP.

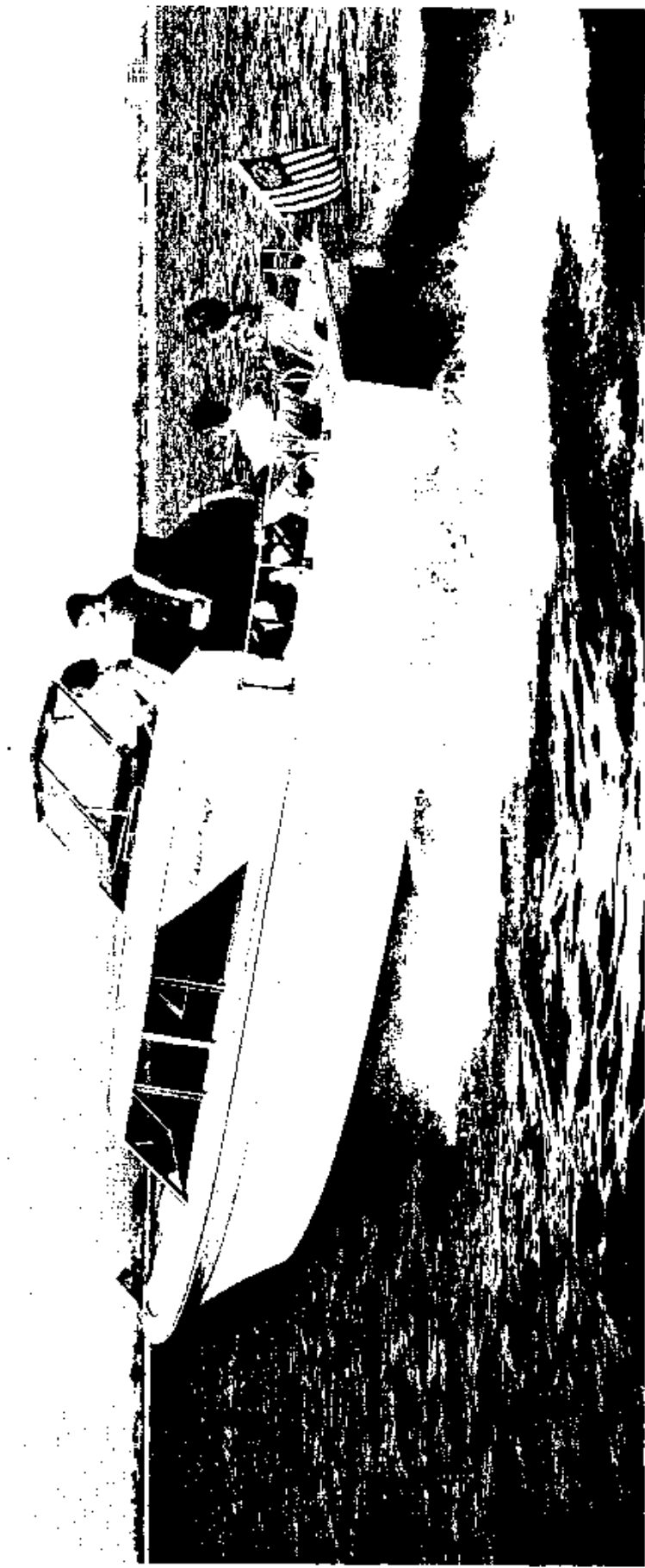

Chris-Craft • 1969 27' COMMANDER



SPECIFICATIONS

| | |
|---|-------------|
| Sleeping Capacity | 4 |
| Length | 27'0" |
| Beam | 10'3" |
| Draft (single screw) | 25 1/4" |
| Draft (twin screw) | 22 1/4" |
| Freeboard, forward | 51 3/4" |
| Freeboard, aft | 37 3/4" |
| Height from waterline (clearance) to top of mast | 9'3" |
| Weight (lbs., estimated) | 5,915-7,174 |
| Headroom | 6'3" |
| Fuel Capacity, gallons (single screw) | 48 |
| Fuel Capacity, gallons (twin screw) | 80 |
| Fresh-water Capacity, gallons | 18.5 |
| Forward, Side and Aft Decks | Fiberglass |
| Cockpit Floor | Fiberglass |

MORE THAN \$1,100 IN EQUIPMENT ADDED AS STANDARD ON 1969 MODEL*

- Anchor and Nylon Line
- Bilge Blower
- Dockside Wiring 115V AC 30 amp 3-wire inlet with shore cable, adapter and 3-wire cabin outlets
- Draperies
- Electric Bilge Pump, automatic
- Fresh Water Pressure System
- Helmsman and Companion Seats with folding footrest
- Muffler
- Screens
- Windshield Wiper

* Compared to 1968 model and based on accessory price list of March 1, 1968.

STANDARD EQUIPMENT

- Anchor and Nylon Line
- Battery Disconnect Switches
- Bilge Blower
- Bow Pole and Pennant
- Carpeting
- Checks and Cleats
- Cockpit Paneling
- Cockpit Rail
- Convertible Dinette
- Deck Hatch, forward
- Dock Lines, nylon
- Dockside Wiring 115V AC 30 amp 3 wire inlet with shore cable, adapter and 3-wire cabin outlets
- Draperies
- Electric Bilge Pump, automatic
- Electric Horn
- Fire Extinguishers
- Foam Cushions and Mattresses
- Fog Bell
- Cold Water Pressure System
- Galley with Alcohol Stove, Ice Box, Sink
- Handrails on cabin top
- Helmsman and Companion Seats with folding footrest
- International Navigation Lights
- Life Preservers
- Mast with Anchor Light
- Mirror in Lavatory
- Muffler
- Screens
- Shipping Cradle
- Stern Pole and Ensign
- Toilet, manual
- Ventilating Windshield
- Windshield Wiper

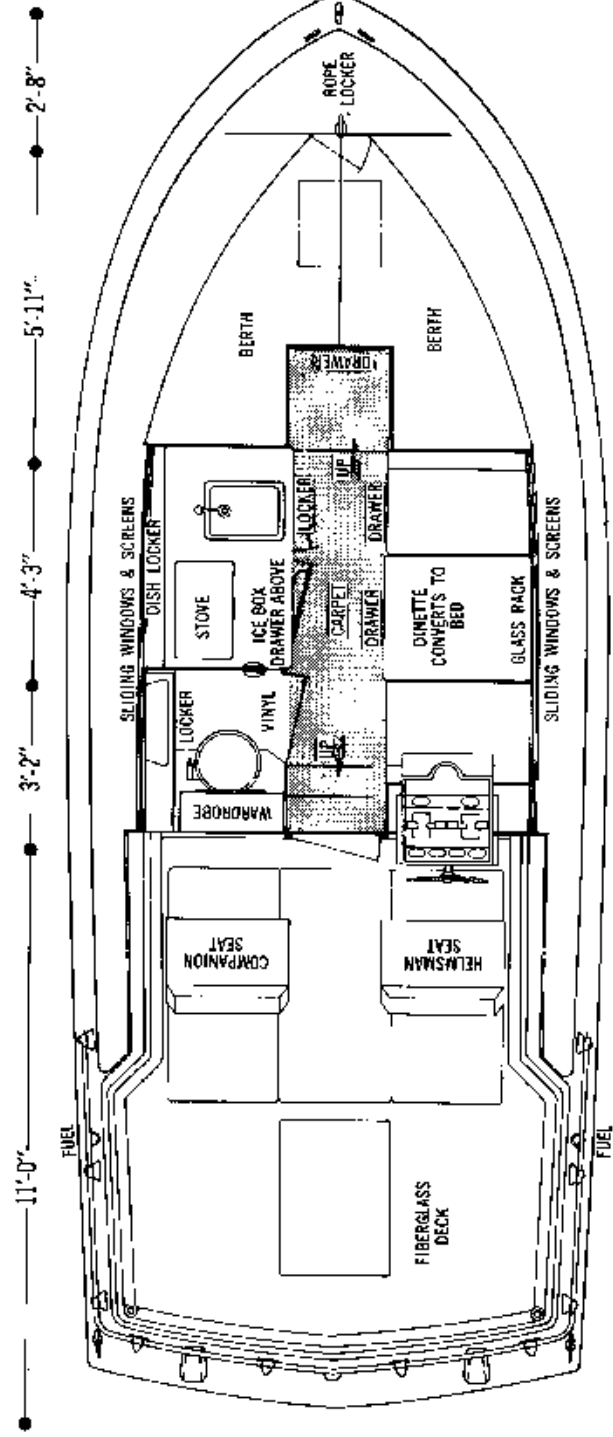

All illustrations and specifications contained in this literature are based on the latest product information available at the time of publication approval. The right is reserved to make changes at any time without notice in prices, colors, materials, equipment, specifications and models, also to discontinue models.

CHRIS-CRAFT DIVISION

Chris-Craft Corporation, Pompano Beach, Florida

Chris-Craft® 1969 27' Commander Sports Express

Name it with this adaptable boat and it's yours. High performance? Try the standard hardtop version. Speeds to 39 MPH with twin 200-HP power. Cruising? Choose optional galley and convertible dinette installations to cruise four (standard V-berth platforms and optional toilet forward). Fishing? Add the optional Command Bridge and watch the action in the huge cockpit. New standard equipment items add comfort, convenience, and value to this versatile boat — see back page.

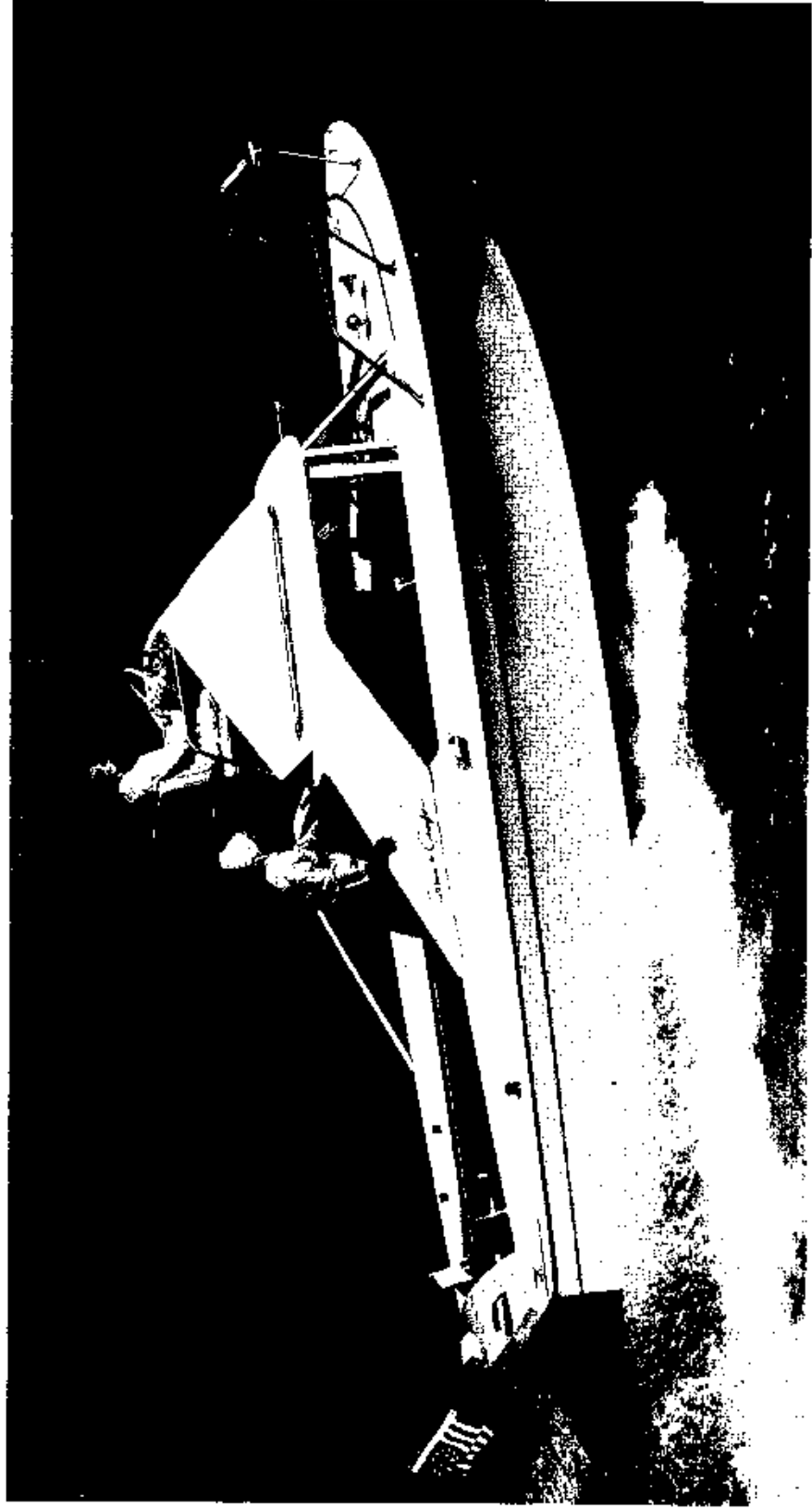

Chris-Craft® 1969 27' COMMANDER SPORTS EXPRESS

STANDARD EQUIPMENT

- Anchor and Nylon Line
- Bilge Blower
- Bow Pole and Pennant
- Chocks and Cleats
- Cockpit Paneling
- Cockpit Step
- Deck Hatch, forward
- Dock Lines, nylon
- Electric Bilge Pump, automatic
- Electric Horn
- Fire Extinguishers
- Fog Bell
- Handrails on Hard Top
- Hardtop with ventilating windshield and sliding side shields
- Helmsman and Companion Seats with folding footrest
- International Navigation Lights
- Life Preservers
- Mast with Anchor Light and Bow Lights
- Mufflers
- Shipping Cradle
- Stern Pole and Ensign
- Ventilating Windshield
- Windshield Wiper

SPECIFICATIONS

| | |
|-----------------------------------|---------------|
| Sleeping Capacity | 2 |
| Length | 27'0" |
| Beam | 10'3" |
| Draft (twin screw) | 22 1/4" |
| Freeboard, forward | 51 3/4" |
| Freeboard, aft | 37 1/4" |
| Height from waterline (clearance) | 7'9" |
| Weight (lbs., estimated) | 6,436 |
| Headroom | 6'2" |
| Fuel Capacity, gallons | 80 |
| Forward, Side and Aft Decks | Fiberglass |
| Cockpit Floor | Vinyl-covered |
| Bottom | Fiberglass |
| Hullsides | Fiberglass |

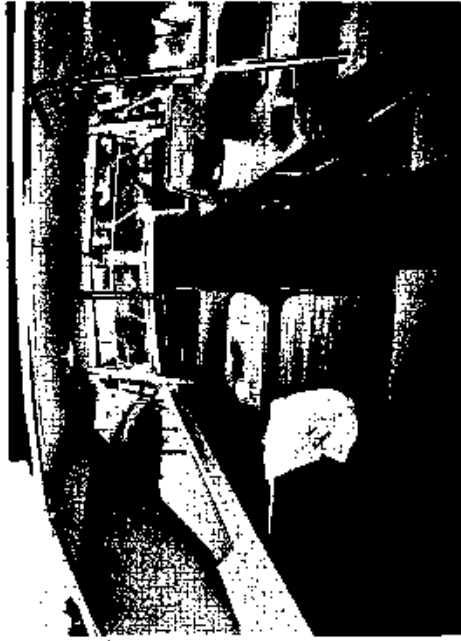

Optional Convertible Dinette Galley

1'-8" — 5'-7" — 3'-9" — 7'-4" — 8'-8"

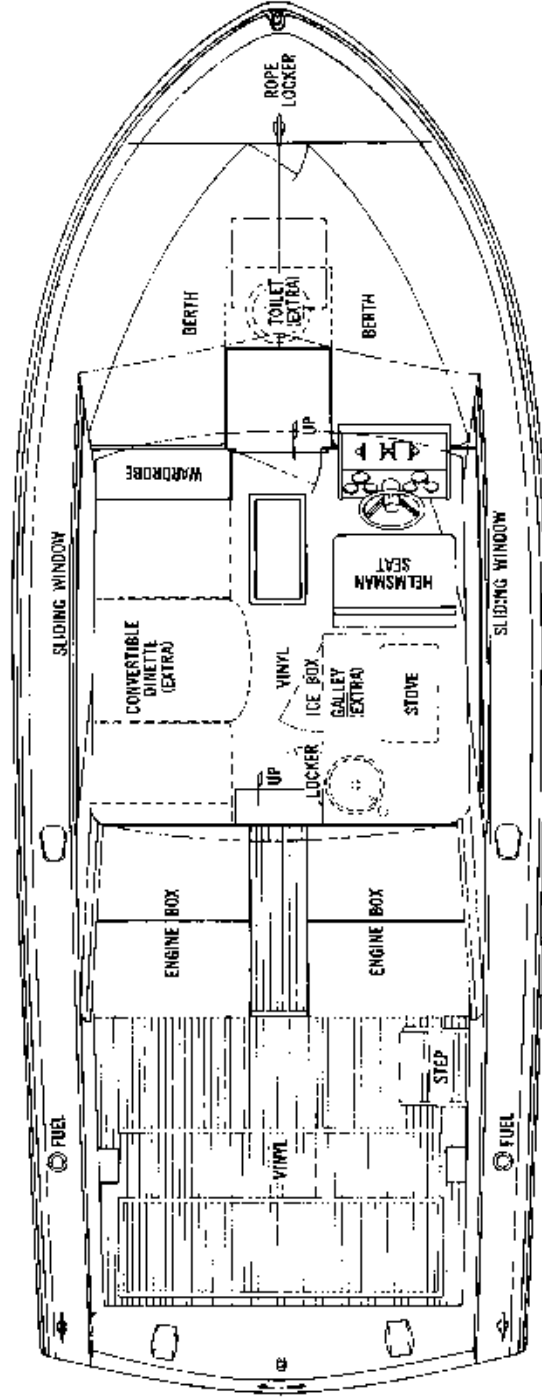

MORE THAN \$1,300 IN EQUIPMENT ADDED AS STANDARD ON 1969 MODEL*

- Anchor and Nylon Line
- Bilge Blower
- Bilge Pump, automatic
- Handtop
- Mufflers
- Windshield Wiper

* Compared to equivalent 1968 model and based on March 1, 1968 Optional Equipment Price List.

All illustrations and specifications contained in this literature are based on the latest product information available at the time of publication approval. The right is reserved to make changes at any time without notice in prices, colors, materials, equipment, specifications and models, also to discontinue models.

CHRIS-CRAFT DIVISION

Chris-Craft Corporation, Pompano Beach, Florida

Chris-Craft. 1969 31' Commander

Pleasurable cruising for six . . . and luxury is the keynote. The private forward stateroom has its own wardrobe and storage under berths. The spacious L-shaped galley is designed for easy installation of electric range and under-counter refrigerator. A shower is optional for the lavatory. Equipment frequently offered as optional in other boats this size, but standard in the 31' Commander, includes bilge blower, mufflers, cold water pressure system, windshield wipers, companion seat, and 115-V AC wiring for shore hookup. Powered by twin 230-HP V-8's, top speed is 36 MPH. Cruise control and hardtop with ventilating sideshields extra.

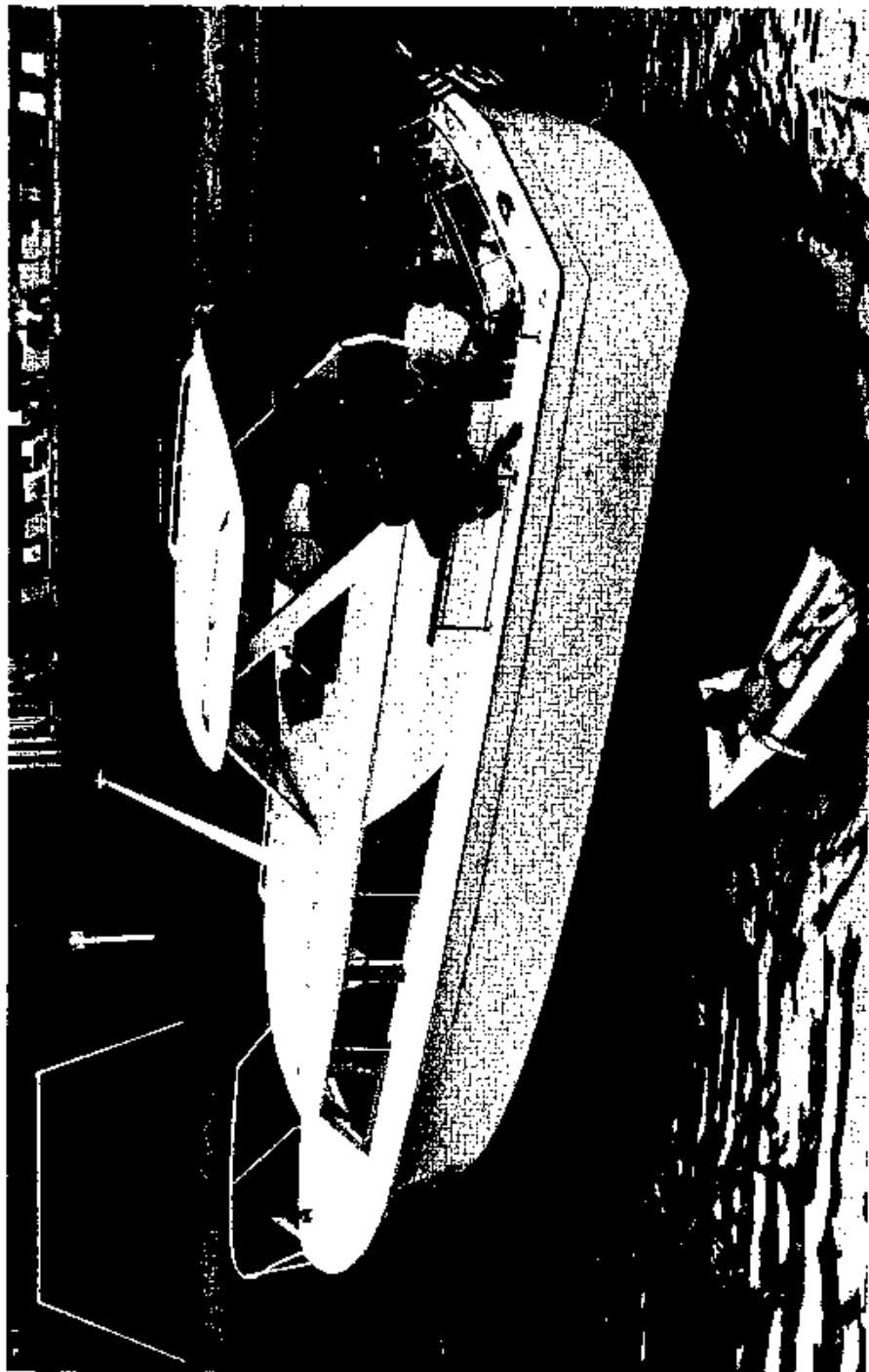
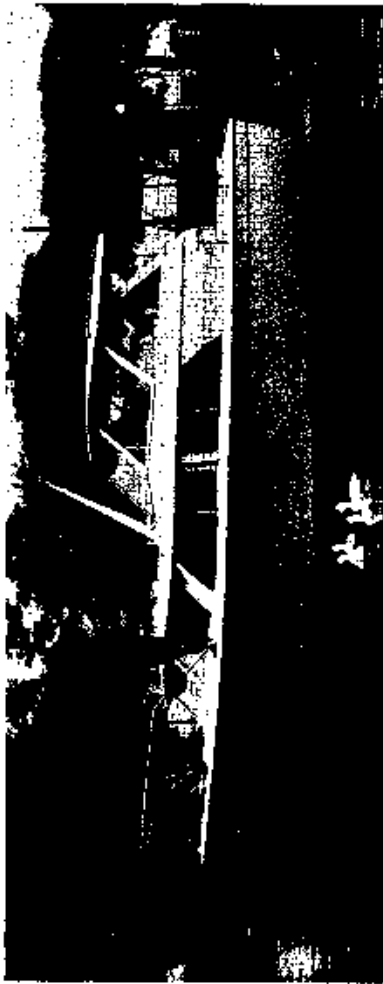

Chris-Craft • 1969 31' COMMANDER

SPECIFICATIONS

| | |
|---|------------|
| Sleeping Capacity | 6 |
| Length | 31'0" |
| Beam | 11'3 3/8" |
| Draft | 27 3/4" |
| Freeboard, forward | 54 3/4" |
| Freeboard, aft | 38 1/2" |
| Weight (lbs., estimated) | 9,682 |
| Height from waterline (clearance) to top of mast | 10'9" |
| Headroom | 6'3 1/4" |
| Fuel Capacity, gallons | 100 |
| Fresh-water Capacity, gallons | 25 |
| Forward, Side and Aft Decks | Fiberglass |
| Cockpit Floor | Fiberglass |

STANDARD EQUIPMENT

- Anchor and Nylon Line
- Battery Disconnect Switches
- Bilge Blower
- Bow Pole and Pennant
- Carpeting
- Chocks and Cleats
- Cockpit Paneling
- Cockpit Rail with Gates
- Convertible Dinette
- Deck Hatch, forward, aluminum with vent
- Dock Lines, nylon
- Dockside Wiring 115V AC 30 amp
- 3 wire inlet with shore cable, adapter and 3-wire cabin outlets
- Draperies
- Electric Bilge Pump, automatic
- Electric Horns
- Fire Extinguishers
- Foam Cushions and Mattresses
- Fog Bell
- Cold Water Pressure System
- Galley with Alcohol Stove, Ice Box, Sink
- Handrails on cabin top
- Helmsman and Companion Seats with folding foot rest
- International Navigation Lights
- Life Preservers
- Lounge, converts to upper and lower berths
- Mast with Anchor Light
- Mirror in Lavatory
- Mufflers
- Radio Ground
- Screens
- Shipping Cradle
- Stern Pole and Ensign
- Toilet, manual
- Ventilating Windshield
- Weather Cloths
- Windshield Wipers (2)

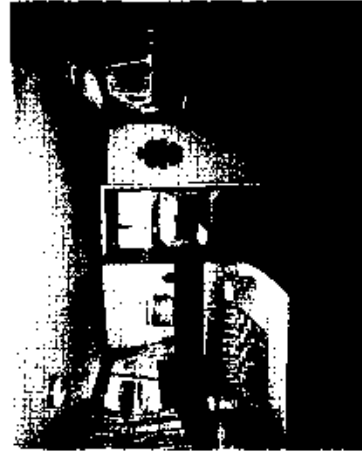

Cabin Interior



Galley

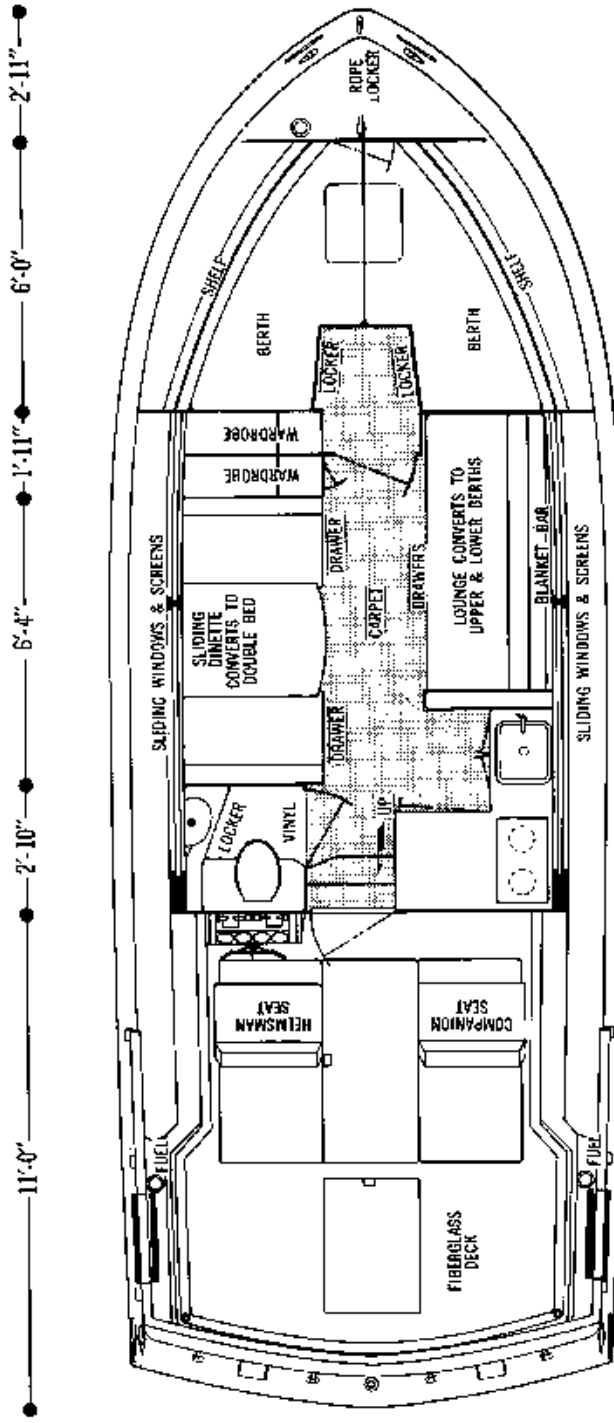

All illustrations and specifications contained in this literature are based on the latest product information available at the time of publication approval. The right is reserved to make changes at any time without notice in prices, colors, materials, equipment, specifications and models, also to discontinue models.

Chris-Craft • 1969 31' Commander Sedan

New and unique in many ways, this comfortable all-purpose Commander has plenty to offer a cruising party of six. The large private forward stateroom has a huge wardrobe and its own entrance to the lavatory (shower standard). Another entrance leads to the main cabin. The galley is extra-long, with an electric refrigerator equipped with a special Weekender "holdover" unit which continues to cool food and freeze cubes for extended periods away from dockside power. The deckhouse has a helm seat, a long lounge (both standard) and a sliding door aft. Twin 230-HP V-8 engines; speeds to 35 MPH. A Command Bridge is optional.

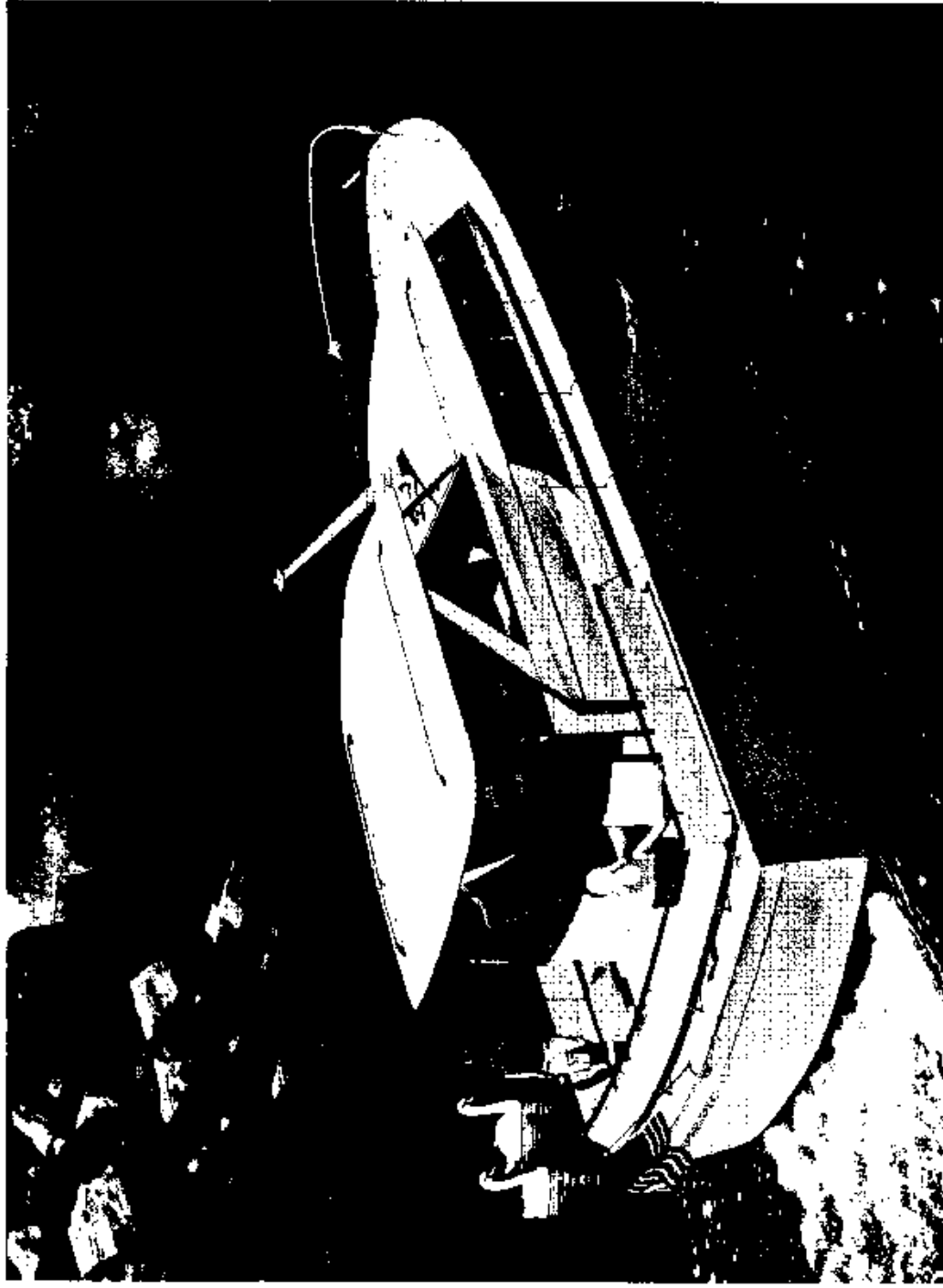

Chris-Craft • 1969 31' COMMANDER SEDAN

STANDARD EQUIPMENT

- Anchor and Nylon Line
- Bilge Blower
- Bow Pole and Pennant
- Cockpit Paneling
- Cockpit Rail with Gates
- Convertible Dinette
- Deck Hatch, forward
- Dock Lines, nylon
- Draperies
- Electric Bilge Pump, automatic
- Electric Horn
- Fire Extinguishers
- Foam Cushions and Mattresses
- Fog Bell
- Fresh Water Pressure System
- Hot and Cold
- Galley with Alcohol Stove, 115V
- Refrigerator with Weekender Unit
- Hardtop
- Helmsman Seats with folding foot rest
- International Navigation Lights
- Life Preservers
- Mirrors in Lavatory
- Mufflers
- Radio Ground
- Screens
- Shipping Cradle
- Shower
- Stern Pole and Ensign
- Toilet, manual
- Ventilating Windshield
- Weather Cloths
- Windshield Wipers (2)
- 115V Wiring with Circuit Breaker
- Fusing

SPECIFICATIONS

| | |
|---------------------------------|------------|
| Sleeping Capacity | 6 |
| Length | 31'0" |
| Beam | 11'3 1/8" |
| Draft | 27 3/4" |
| Freeboard Forward | 54 3/4" |
| Freeboard Aft | 35 1/2" |
| Height from Waterline (mast up) | 10'9" |
| Weight (lbs., estimated) | 11,500 |
| Headroom | 6'3 1/2" |
| Fuel Capacity, gallons | 100 |
| Fresh Water Capacity, gallons | 25 |
| Decks and Cockpit Floor | Fiberglass |

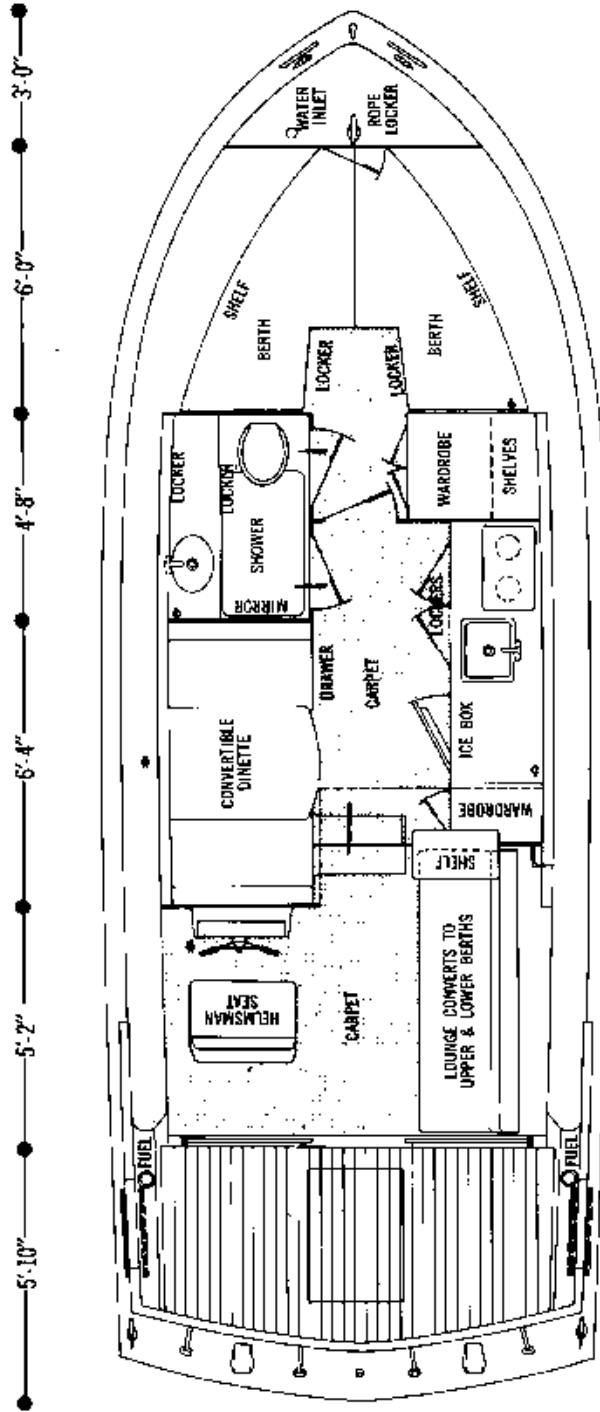

All illustrations and specifications contained in this literature are based on the latest product information available at the time of publication approval. The right is reserved to make changes at any time without notice in prices, colors, materials, equipment, specifications and models, also to discontinue models.

CHRIS-CRAFT DIVISION

Chris-Craft Corporation, Pompano Beach, Florida

Chris-Craft - 1969 31' Commander Sports Express

A great favorite with sport fishermen, this Commander boasts speeds that few others can match. Twin 230 and 300 HP V8's are the choices, and the latter deliver 39 MPH. The control station with standard helmsman's seat is to port, and opposite is a fully enclosed lavatory. Twin berths in the private stateroom forward sleep two, and two more can sleep aboard with the addition of an optional convertible dinette. A galley is also available. Plenty of storage throughout, including generous space under the aft deck. Equipment, previously offered as optional, but now standard, includes bilge blower, mufflers, cold water pressure system and windshield wiper.



Command Bridge Optional



Chris-Craft - 1969 31' COMMANDER SPORTS EXPRESS

STANDARD EQUIPMENT

- Anchor and Nylon Line
- Battery Disconnect Switches
- Bilge Blower
- Bow Pole and Pennant
- Chocks and Cleats
- Cockpit Paneling
- Cockpit Rail with Gates
- Cockpit Step
- Deck Hatch, forward
- Dock Lines, nylon
- Electric Bilge Pump, automatic
- Electric Horns
- Fire Extinguishers
- Foam Cushions and Mattresses
- Fog Bell
- Cold Water Pressure System
- Handrails on cabin top
- Hardtop
- Helmsman Seat with folding foot rest
- International Navigation Lights
- Life Preservers
- Mast with Anchor Light
- Mirror in Lavatory
- Mufflers
- Radio Ground
- Shipping Cradle
- Stern Pole and Ensign
- Toilet, manual
- Ventilating Windshield
- Windshield Wipers (2)

SPECIFICATIONS

| | |
|---|--------------|
| Sleeping Capacity | 2 |
| Length | 31'0" |
| Beam | 11'3 1/8" |
| Draft | 27 1/4" |
| Freeboard, forward | 57" |
| Freeboard, aft | 39 1/2" |
| Height from waterline (clearance) to top of mast | 9'3" |
| Height from waterline with Command Bridge to top of mast | 11'3 1/4" |
| Weight (lbs., estimated) | 9,320-10,018 |
| Headroom | 64" |
| Fuel Capacity, gallons | 150 |
| Fresh-water Capacity, gallons | 25 |
| Forward, Side and Aft Decks | Fiberglass |
| Cockpit Floor | Fiberglass |



1'-10" 10'-7" 6'-5" 3'-2" 6'-0" 3'-0"

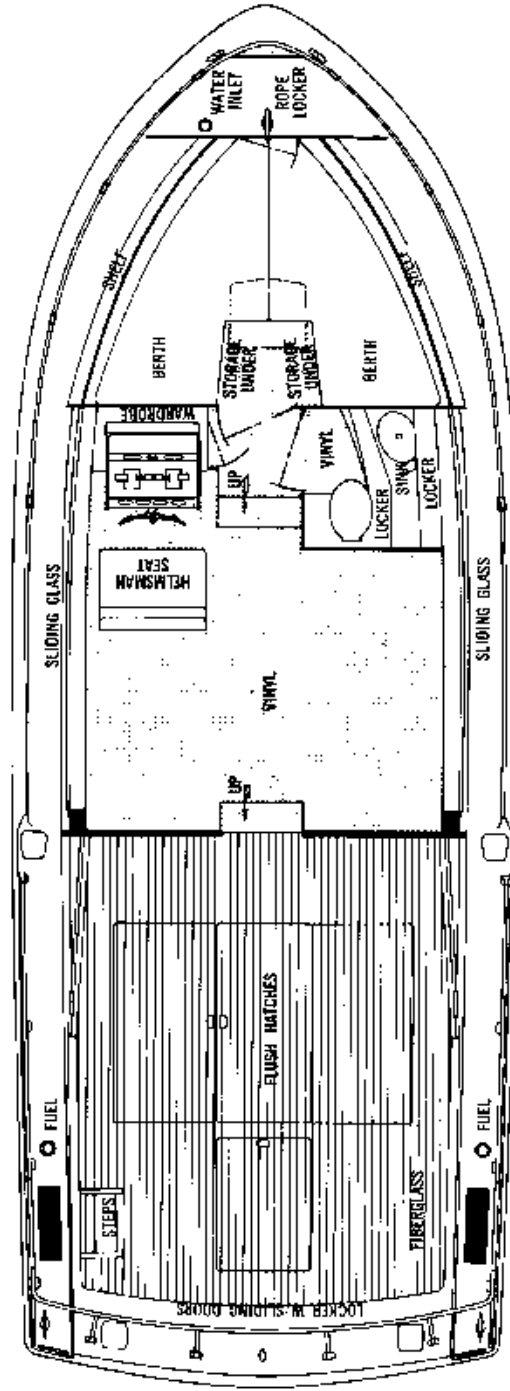

All illustrations and specifications contained in this literature are based on the latest product information available at the time of publication approval. The right is reserved to make changes at any time without notice in prices, colors, materials, equipment, specifications and models, also to discontinue models.

CHRIS-CRAFT DIVISION

Chris-Craft Corporation, Pompano Beach, Florida

Chris-Craft, 1969 35' Commander

Complete facilities for cruising six, plus outstanding performance have made this one of the most popular Commander models. Standard equipment adding to cruising comfort includes electric refrigerator and range, hot and cold water pressure system, and 115V AC wiring for shore hookup. See complete list back page. A new non-absorbent material called polypropylene is standard for berth covers. Due to a 13' beam, the main cabin is wide and spacious for entertaining. Decks are in Chris-Craft's now famous teak-pattern fiberglass. Twin 230-HP or 300-HP engines; top speed is 35 MPH.



Command Bridge Optional

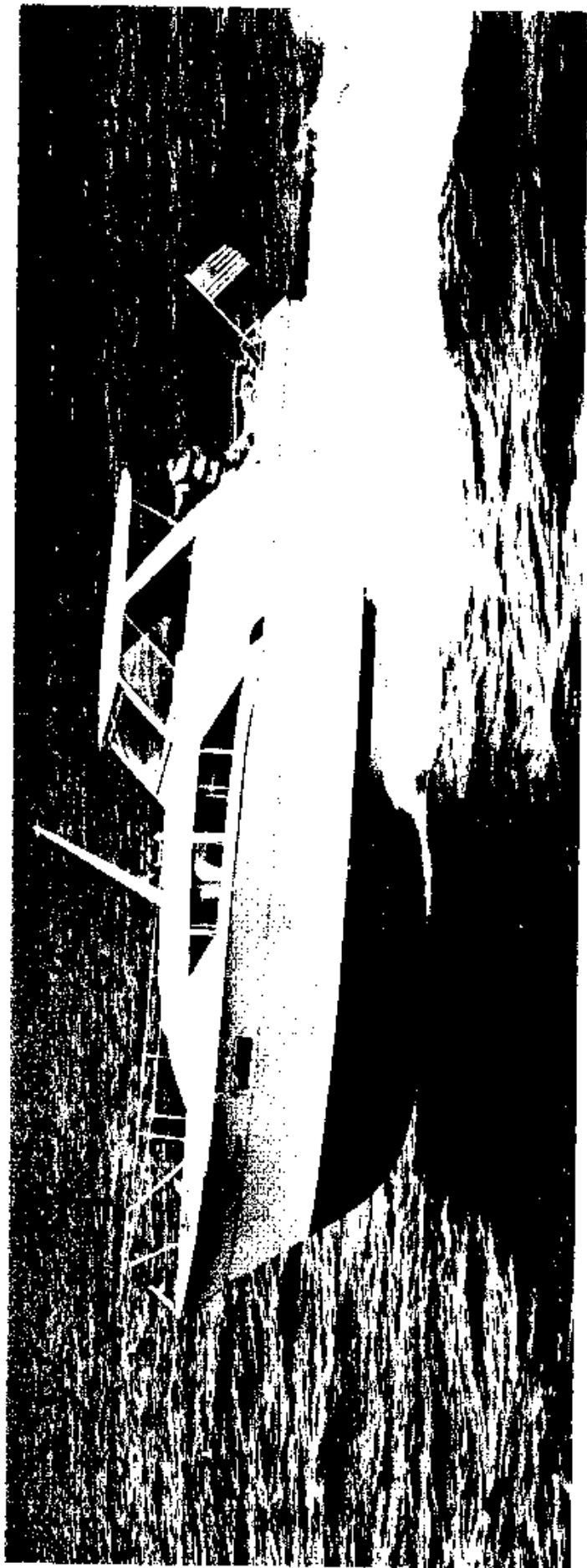

Chris-Craft 1969 35' COMMANDER

MORE THAN \$1,600 IN EQUIP- MENT ADDED AS STANDARD ON 1969 MODEL*

- Bilge Blower
- Dockside Wiring 115V AC 30 amp 3-wire inlet with shore cable, adapter and 3-wire cabin outlets
- Fresh Water Pressure System, Hot and Cold
- 6.5 cu. ft. Electric Refrigerator and 3 burner Electric Range with oven and rotisserie
- Companion Seat with folding footrest
- Windshield Wipers (2)

* Compared to 1968 model and based on accessory price list of March 1, 1968.

STANDARD EQUIPMENT

- Anchor and Nylon Line
- Battery Disconnect Switches
- Bilge Blower
- Bow Pole and Pennant
- Carpeting
- Checks and Cleats
- Circuit Breaker Fusing
- Cockpit Rail with Gates
- Cockpit Step
- Convertible Dinette
- Deck Hatch, forward, aluminum with vent
- Dock Lines, nylon
- Dockside Wiring 115V AC 30 amp 3-wire inlet with shore cable, adapter and 3-wire cabin outlets
- Draperies
- Electric Bilge Pump, automatic
- Electric Horns
- Fire Extinguishers
- Foam Cushions and Mattresses
- Fog Bell
- Fresh Water Pressure System, Hot and Cold
- Galley with Stainless Steel Sink, 6.5 cu. ft. Electric Refrigerator and 3 burner Electric Range with oven and rotisserie
- Handrails on cabin top and Hardtop
- Hardtop
- Helmsman and Companion Seats with folding footrest
- International Navigation Lights
- Life Preservers
- Lounge, converts to upper and lower berths
- Mast with Anchor Light
- Mirrors in Lavatory
- Mooring Bitt with Rope Deck Opening
- Mufflers
- Radio Ground
- Screens
- Shipping Cradle
- Stern Pole and Ensign
- Sun Lounge, forward deck
- Toilet, manual
- Windshield Wipers (2)

SPECIFICATIONS

| | |
|---|---------------|
| Sleeping Capacity | 6 |
| Length | 35'0" |
| Beam | 13'0" |
| Draft | 35 1/2" |
| Freeboard, forward | 67 1/2" |
| Freeboard, aft | 45 1/2" |
| Weight (lbs., estimated) | 13,478-13,994 |
| Height from waterline (clearance), to top of mast | 11'5" |
| Headroom | 64 1/4" |
| Fuel Capacity, gallons | 175 |
| Fresh-water Capacity, gallons | 50 |
| Forward, Side and Aft Decks | Fiberglass |
| Cockpit Floor | Fiberglass |

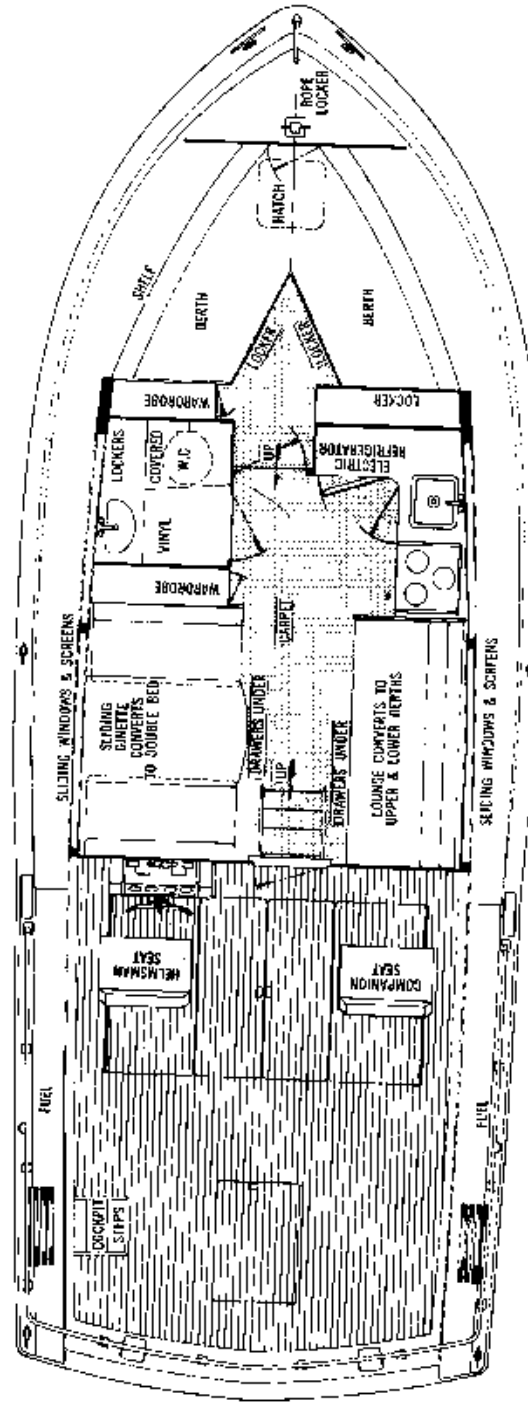

All illustrations and specifications contained in this literature are based on the latest product information available at the time of publication approval. The right is reserved to make changes at any time without notice in prices, colors, materials, equipment, specifications and models, also to discontinue models.

CHRIS-CRAFT DIVISION
Chris-Craft Corporation, Pompano Beach, Florida

Chris-Craft • 1969 35' Commander Sports Cruiser

All the advantages of a sportfisherman model — plus those of a luxury sedan — are wrapped up in this brand-new Commander. The boat has two private staterooms. One is forward and features an ingenious "lazy susan" device under the vee-berths which gives you five triangular storage bins 7" deep, accessible one at a time as the unit rotates. A second stateroom is amidships to starboard, opposite a lavatory with a separate stall shower. The deckhouse has a convertible lounge and hi-lo table. The wide Command Bridge is standard. Twin 230-HP or 300-HP V-8 engines, the latter delivering 35 MPH. Cruise Control is optional.

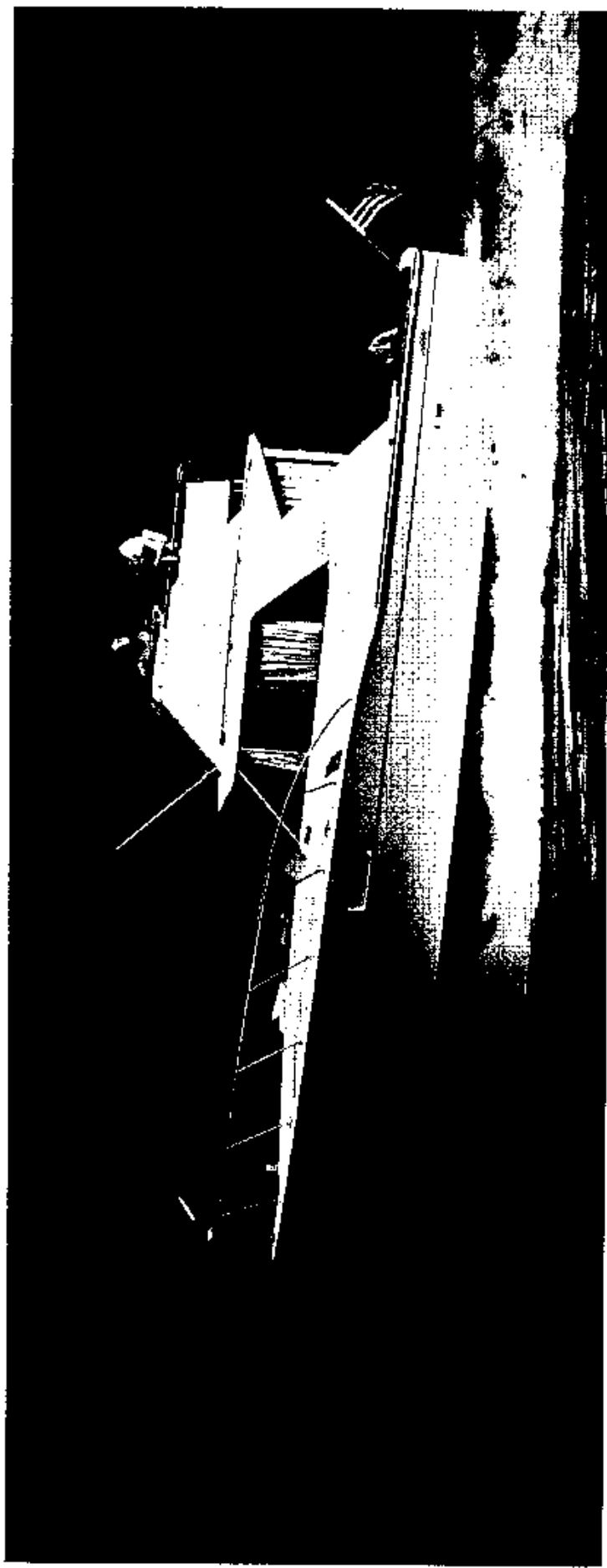

Chris-Craft

1969 35' COMMANDER SPORTS CRUISER

STANDARD EQUIPMENT

- Anchor and Nylon Line
- Battery Disconnect Switches
- Bilge Blower
- Bow Pole and Pennant
- Bow Rail
- Circuit Breaker Fusing
- Cockpit Step
- Command Bridge
- Deck Hatch, forward, aluminum with vent
- Dock Lines, nylon
- Dockside Wiring, 115V AC 30 amp, 3 wire inlet with shore cable, adapter and 3-wire cabin outlets
- Draperies
- Electric Bilge Pump, automatic
- Electric Horns
- Fire Extinguishers
- Foam Cushions and Mattresses
- Fog Bell
- Fresh Water Pressure System, Hot and Cold
- Galley with Stainless Steel Sink, 6.5 cu. ft. Electric Refrigerator and 3 burner Electric Range with oven and rotisserie
- Handrails on cabin top and Hardtop
- Helmsman Seat with folding foot rest
- Hi-Lo drop leaf Table
- Hot Water Heater
- International Navigation Lights
- Life Preservers
- Mirrors in Lavatory
- Mooring Bitt with Rope Deck Opening
- Mufflers
- Radio Ground
- Screens
- Shipping Cradle
- Shower
- Stern Pole and Ensign
- Toilet, manual
- Windshield Wipers (2)

SPECIFICATIONS

| | |
|--|---------------|
| Sleeping Capacity | 6 |
| Length | 35'0" |
| Beam | 13'0" |
| Draft | 35½" |
| Freeboard, forward | 67½" |
| Freeboard, aft | 45½" |
| Weight (lbs., estimated) | 13,271-13,890 |
| Height from waterline (clearance) to top of mast | 12'6" |
| Headroom | 6'5" |
| Fuel Capacity, gallons | 250 |
| Fresh-water Capacity, gallons | 75 |
| Decks and Cockpit Floor | Fiberglass |

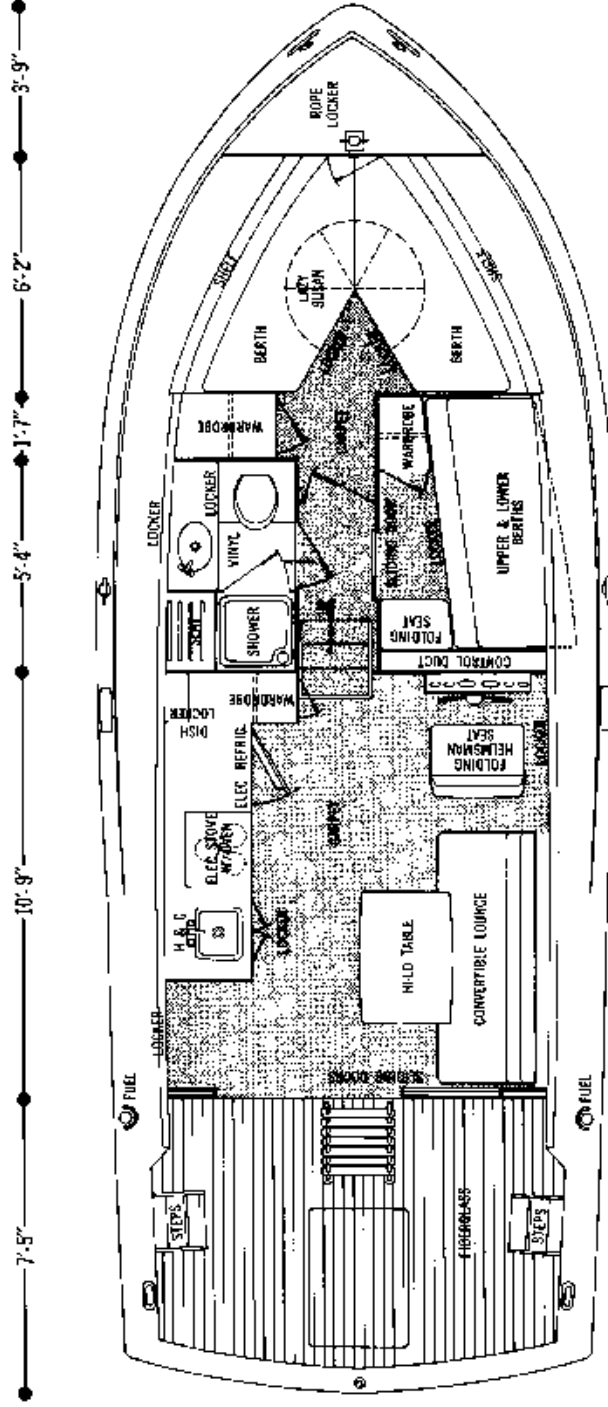

All illustrations and specifications contained in this literature are based on the latest product information available at the time of publication approval. The right is reserved to make changes at any time without notice in prices, colors, materials, equipment, specifications and models, also to discontinue models.

CHRIS-CRAFT DIVISION
Chris-Craft Corporation, Pompano Beach, Florida

Chris-Craft, 1969 38' Commander

The model that started a revolution in fiberglass cruisers is in its fifth year of refinements and improvements. Cruise Control, Chris-Craft's unique system of altering trim with faired in tabs, is now standard on all engine options. In the forward section there's the privacy of an enclosed stateroom, with a large wardrobe and adjoining lavatory and shower. A new material, polypropylene, is used for berth covering and other upholstery. It is highly stain and water resistant. The galley has electric appliances, and a cover over the 3-burner electric range provides more counterspace when needed. Twin 300-HP V-8 engines, with speeds to 33 MPH, or 197 or 258-HP diesels.



Chris-Craft 1969 38' Commander Sedan

The unique interior layout of this model has become extremely popular with boatmen seeking versatility. The forward stateroom is similar to the standard 38" Commander, but the main cabin features an enormous electric galley, and an L-shaped dinette area which becomes a private stateroom at night. The deckhouse has a long convertible lounge, which brings the sleeping capacity to six. Command Bridge optional. Twin 300-HP V-8 engines or 197 or 258-HP diesels. Speeds to 33 MPH. New standard equipment includes Cruise Control (gas as well as diesel), helmsman seat, and windshield wipers.

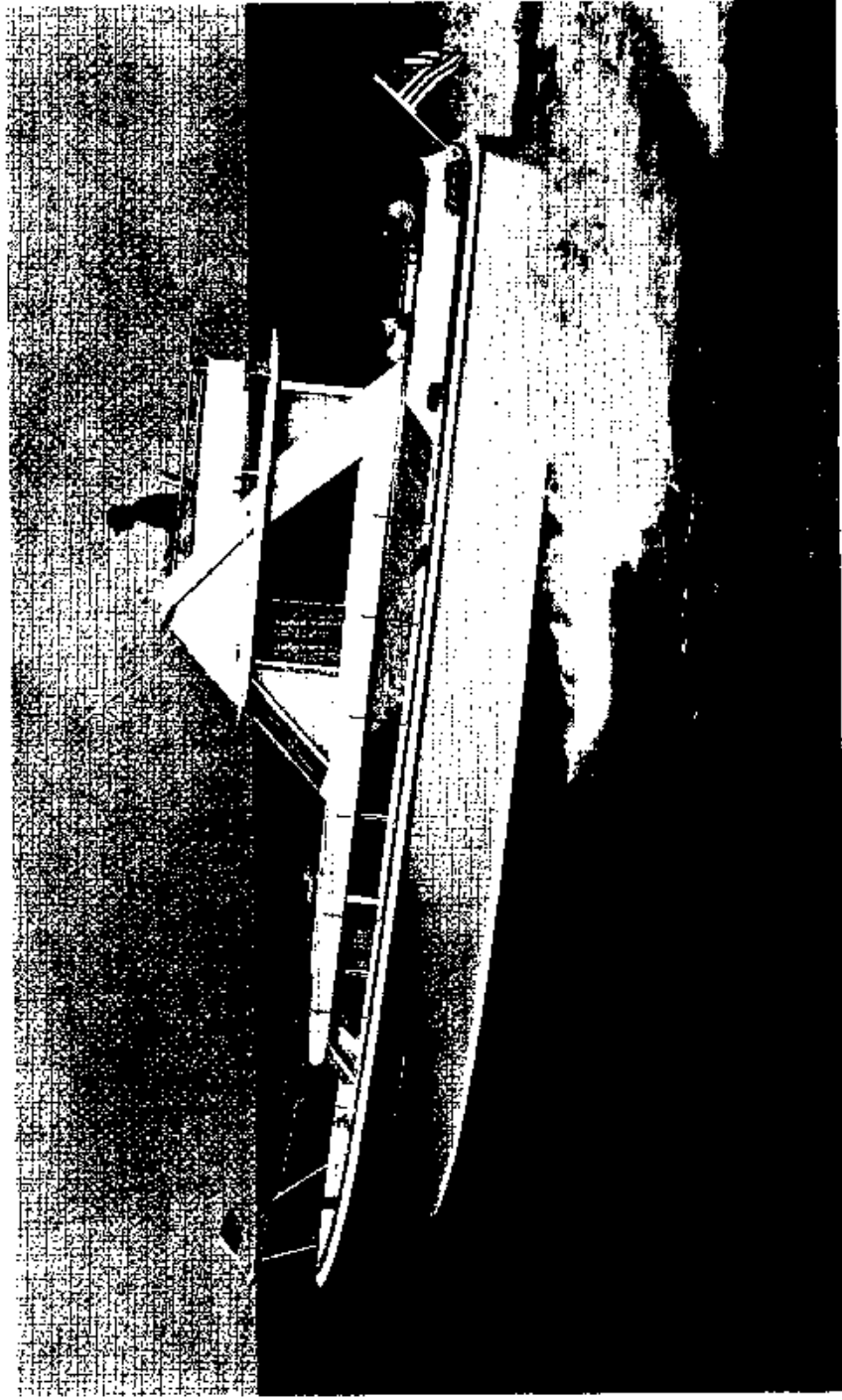

Chris-Craft® 1969 38' COMMANDER SEDAN

STANDARD EQUIPMENT

- Anchor and Nylon Line
- Battery Disconnect Switches
- Battery Paralleling Switch — Std. on diesel models only
- Bilge Blower
- Bow Pole and Pennant
- Carpeting
- Cockpit Paneling
- Cockpit Rail with Gates
- Compass
- Convertible Dinette
- Cruise Controls
- Deck Hatch, forward, aluminum with vent
- Dock Lines, nylon
- Docksire Wiring 115V AC 30 amp 3-wire inlet with shore cable, circuit breakers, adapter and 3-wire cabin outlets
- Draperies
- Electric Bilge Pump, automatic
- Electric Horns
- Fire Extinguishers
- Foam Cushions and Mattresses
- Fog Bell
- Fresh Water Pressure System, Hot and Cold
- Galley with Stainless Steel Sink, 6.5 cu. ft. Electric Refrigerator and 3 burner Electric Range with oven and rotisserie and stove cover
- Handrails on cabin top, Hardtop, bow and side decks
- Helmsman Seat
- International Navigation Lights
- Life Preservers
- Lounge, converts to double bed
- Mast with Anchor Light
- Mirror in Lavatory
- Mooring Bitts and Tow Post
- Mufflers
- Radio Ground
- Rope Deck Pipe
- Screens
- Shipping Cradle
- Shower
- Sliding Doors, Aft end of Deckhouse
- Stern Pole and Ensign
- Toilet, electric
- Weather Cloths
- Windshield Wipers (3)

SPECIFICATIONS

| | |
|--|---------------|
| Sleeping Capacity | 6 |
| Length | 38'0" |
| Beam | 13'0" |
| Draft | 36" |
| Freeboard, forward | 63" |
| Freeboard, aft | 44" |
| Height from waterline (clearance) to top of mast | 12'0" |
| Height from waterline to top of Command Bridge | 12'7" |
| Weight (lbs., estimated) | 18,580-21,200 |
| Headroom | 6'4½" |
| Fuel Capacity, gallons | 200 |
| Fresh-water Capacity, gallons | 75 |
| Forward, Side and Aft Decks | Fiberglass |
| Cockpit Floor | Fiberglass |



Forward Berth Section



Enclosed Deckhouse



Cabin Interior

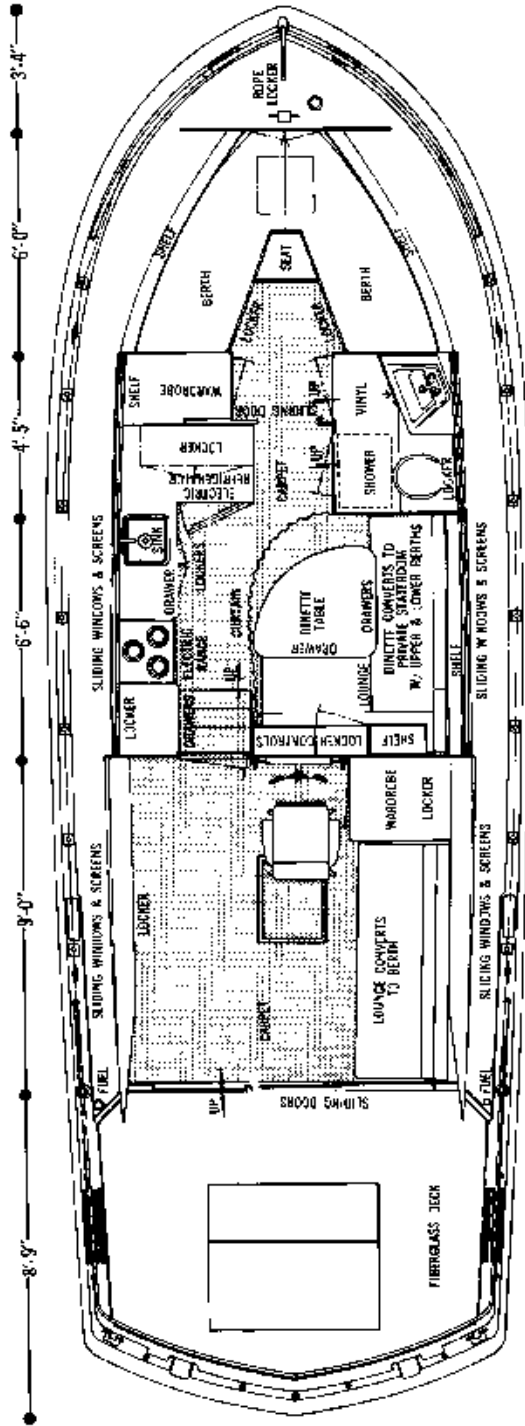

All illustrations and specifications contained in this literature are based on the latest product information available at the time of publication approval. The right is reserved to make changes at any time without notice in prices, colors, materials, equipment, specifications and models, also to discontinue models.

CHRIS-CRAFT DIVISION

Chris-Craft Corporation, Pompano Beach, Florida

Chris-Craft® 1969 42' Commander

Chris-Craft's classic double-cabin fly-bridge design is enhanced by new interior design features and added standard equipment. The galley has been redesigned to place the refrigerator across the companionway on the port side, adding considerably to space on the starboard. Among amenities added for 1969 are a stereo system and an upholstered chair and drop leaf table for the salon. The salon also has a lounge converting to sleep two. The large master stateroom has adjoining lavatory with separate stall shower. A hardtop is optional. 300-HP V-8's provide 29 MPH, also available with 258-HP diesels. Cruise control is now standard for gas as well as diesel power. For other added standard equipment, see back page.



Chris-Craft 1969 42' Commander Sports Cruiser

Introduced last year, the model was acclaimed by cruising men and fishermen alike. Fishermen favored its standard Command Bridge, low freeboard aft, and big fishing cockpit. Cruising men appreciated its functional design featuring two private staterooms and lavatory with enclosed stall shower forward and spacious enclosed deckhouse aft. This year's refinements include a recessed electric refrigerator in the redesigned

galley, which is only a step below the deckhouse salon, and new standard equipment including a stereo system, electric windshield wipers, an upholstered deckhouse chair, and Cruise Control, see back page. The restyled deckhouse has a convertible L-shaped lounge aft and a coffee table that may be raised to dining height. Twin 300-HP V8 or 258-HP diesel engines, speeds to 29 MPH.



Chris-Craft. 1969 47' Commander with Fishing Cockpit

This is the ideal boat for those seeking a luxurious double-cabin flying-bridge cruiser, yet who also enjoy occasional deep sea fishing. Below decks, the master stateroom is exceptionally large, has its own private lavatory with separate staff shower. The mid-ship salon has a lounge converting to sleep two, and a stereo tape deck is standard equipment. A complete all-electric galley is opposite the convertible dinette, and the forward cabin features two full-width berths. The lavatory is forward and a shower is optional. Topsides, a Command Bridge, with dual controls, is standard. Aft on the bridge deck is a two-way lounge — swing the back of the seat forward and you can watch the fishing action in the cockpit below. Note on the back page equipment now included as standard. Power choices are twin Chris-Craft 300-HP V-8's for speeds to 25 MPH, or 258-HP diesels. Cruise Control standard.

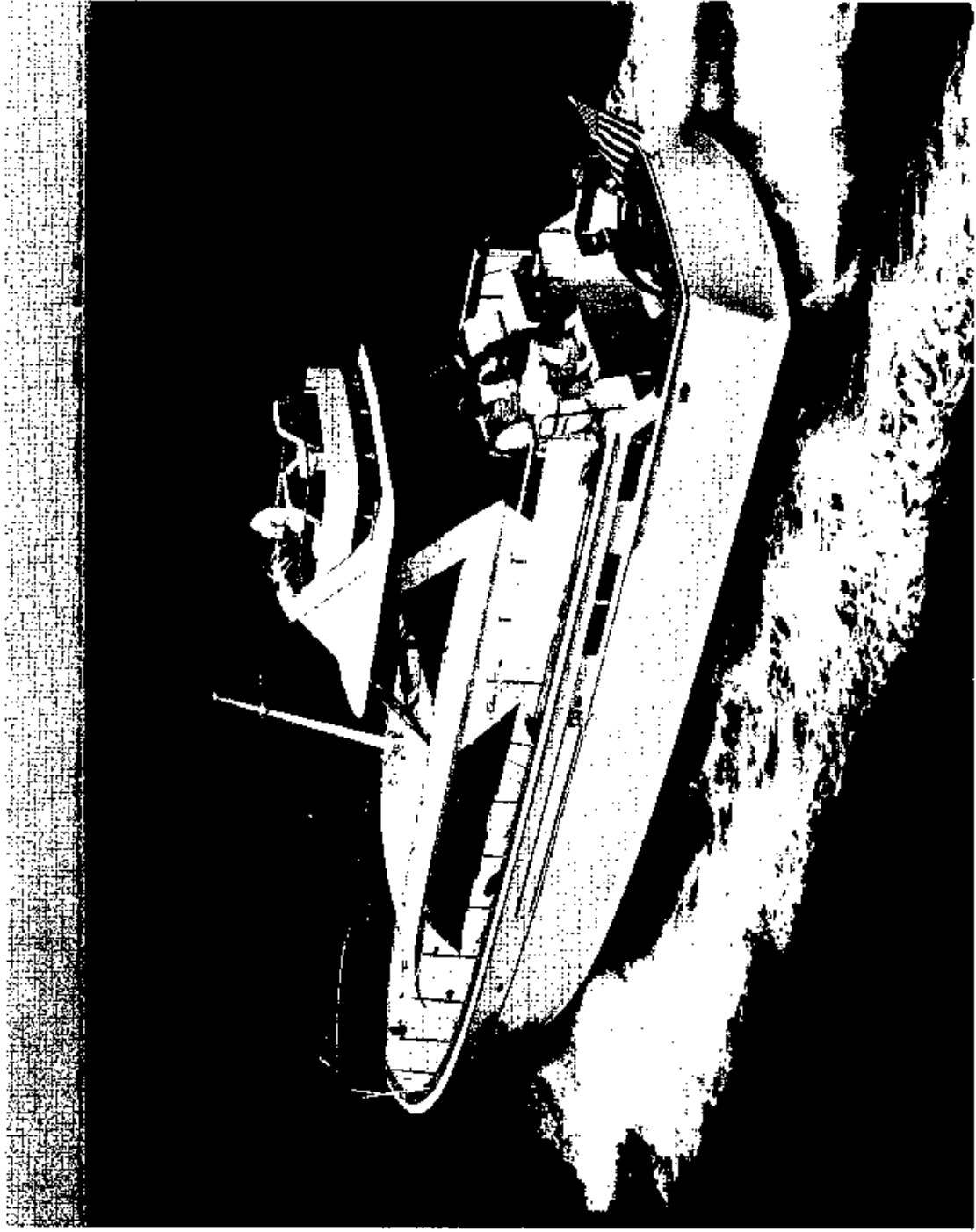

Chris-Craft • 1969 47' COMMANDER WITH FISHING COCKPIT

STANDARD EQUIPMENT

- Alarm System, engine, oil and water
- Anchor and Nylon Line
- Battery Disconnect Switches
- Battery Paralleling Switch
- Bedspreads
- Bilge Blower
- Bow Pole and Pennant
- Carpeting
- Chocks and Cleats
- Circuit Breaker Fusing
- Cockpit Paneling
- Command Bridge with dual controls, Helmman and Companion Seats, Weather Cloths and Windshield
- Compass
- Convertible Dinette
- Cruise Controls
- Deck Hatch, forward, aluminum with vent
- Dock Lines, nylon
- Dockside Wiring 115V AC 30 amp 3-wire inlets with shore cable, adapter, and 3-wire cabin outlets
- Draperies
- Electric Bilge Pump, automatic (2)
- Electric Horns
- Fire Extinguishers
- Foam Cushions and Mattresses
- Fog Bell
- Fresh Water Pressure System, Hot and Cold
- Galley Blower
- Galley with Stainless Steel Sink, 10 cu. ft. Electric Refrigerator and 3 burner Electric Range with oven and rotisserie and stove cover
- Handrails on cabin top, bow, and side decks
- Hardtop
- Helmsman Seat
- International Navigation Lights
- Life Preservers
- Lounge, converts to double bed
- Mast with Anchor Light
- Mirrors in Lavatories and Salon
- Tow Post, forward
- Mufflers
- Radio Ground
- Rope Deck Pipe
- Screens
- Shower
- Stern Pole and Ensign

SPECIFICATIONS

| | |
|--|---------------|
| Sleeping Capacity | 8 |
| Length | 47'0" |
| Beam | 15'0" |
| Draft | 38" |
| Freeboard, forward | 89½" |
| Freeboard, aft | 56½" |
| Height from waterline (clearance) including anchor light | 171" |
| Weight (lbs., estimated) | 30,167-33,255 |
| Headroom | 6'4" |
| Fuel Capacity, gallons | 350 |
| Fresh-water Capacity, gallons | 80 |
| Forward and Side Decks | Fiberglass |
| Aft Deck | Teakwood |
| Cockpit Floor | Vinyl |

MORE THAN \$1,400 IN EQUIPMENT ADDED AS STANDARD ON 1969 MODEL*

- Alarm, Water temperature and oil pressure with bell and light indicators
- Battery Paralleling Switch
- Helmsman Seat
- Stereo tape deck
- Upholstered Occasional Chair
- Windshield Opener, electric

* Compared to 1968 model and based on latest Accessory Price List dated March 1, 1968.

All illustrations and specifications contained in this literature are based on the latest product information available at the time of publication approval. The right is reserved to make changes at any time without notice in prices, colors, materials, equipment, specifications and models, also to discontinue models.

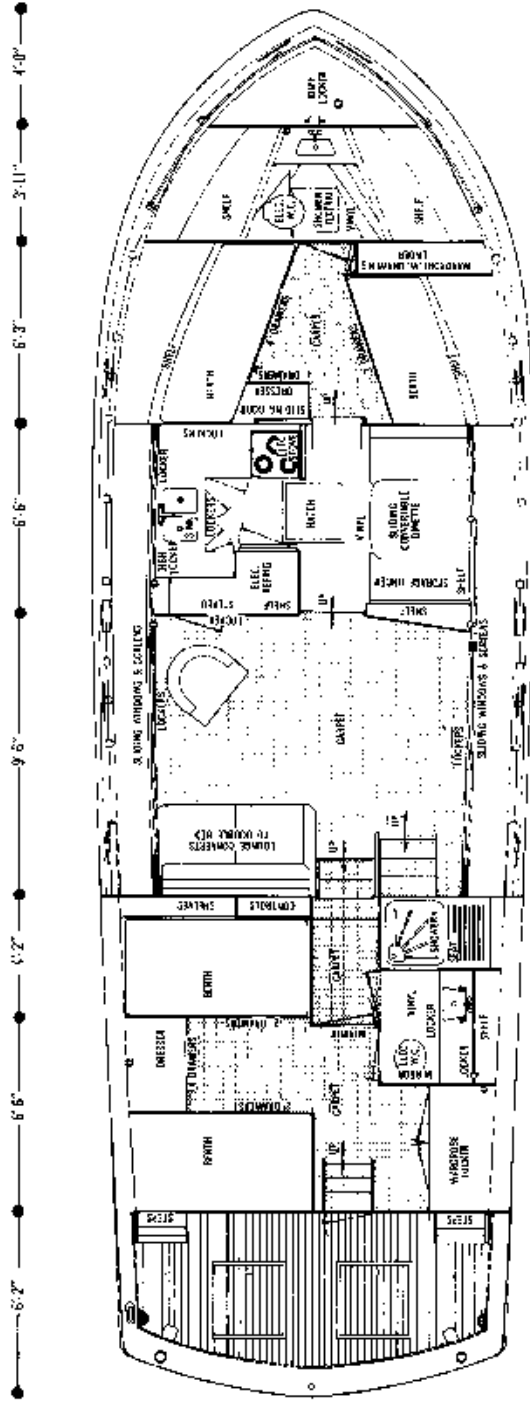

CHRIS-CRAFT DIVISION
Chris-Craft Corporation, Pompano Beach, Florida