

## 422 Hull Numbers

October 18, 2010

I am purchasing a 1985 Chris Craft 422 Convertable, the hull numbers on the transom are CCSYA107J485. The first three letters are not consistent with the Chris Craft format. My research indicates that the letter S was never used. I discussed this with one of the ex Chris Craft factory employees and he believed the boat was built in Swansboro, NC but, if that was the case it should have CCN in the hull number. Is there any information that you can provide to me on this boat?

Thanks, Joe Signorelli

---

Hello Joe,

It is our understanding that CCS was used briefly after Chris Craft acquired Uniflite. A list of model designators we have shows both MICs to be valid. The HIN you quoted below would indicate a 422 Commander built in Swansboro in October, 1984 as a 1985 model.

However, since CCS was already assigned to another company, Cutts and Case of Oxford, MD, Chris Craft had to change to CCN for boats built in Swansboro. It was actually during 1984 that the format for hull numbering was standardized so all the details for registering MICs were probably not well known by the industry.

Attached to this email you will find a handful of images taken from a brochure published by Murray Industries, the owner of Chris Craft at that time. This is all we really know about the boat. We do not have manuals, parts or engineering data for boats built during this era.

Best wishes with your purchase. It is quite a good looking yacht.



422 COMMANDER SPORT SEDAN



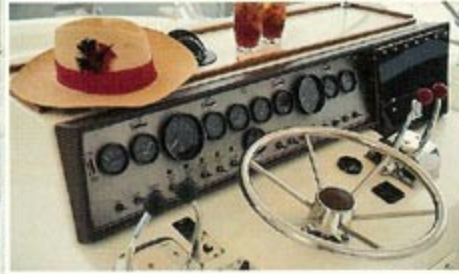



## 422 COMMANDER SPORT SEDAN

SLEEPING CAPACITY	6	
LENGTH	42'3.5"	12.89 m
BEAM	14'0"	4.27 m
DRAFT	3'11"	1.19 m
FREEBOARD FWD.	6'5"	1.96 m
FREEBOARD AFT	3'11"	1.19 m
HEIGHT FROM WATERLINE TO TOP OF COMMAND BRIDGE (clearance)	12'10"	3.91 m
WEIGHT (dry) Diesel	34,000 lbs	15,426 kg
FUEL CAPACITY	525 gals	1,987 lt
FRESH WATER CAPACITY	65 gals	246 lt

### INTERIOR COLOR OPTIONS:

Pecan, Khaki/Navy

### POWER OPTIONS:

2-340 hp Mercruisers

2-390 hp 6-71 TI Diesels

2-465 hp 6V-92 TA Diesels

Diesel engines include fresh water cooling  
& fuel/water separator.

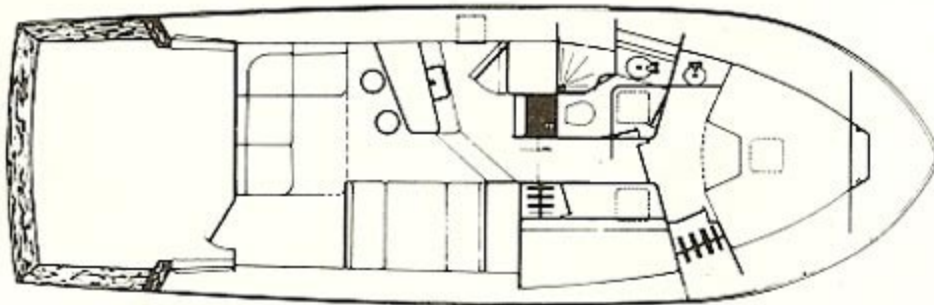

**422 COMMANDER SPORT  
SEDAN**

**General:**

Anchor, w/line & deck pipe  
Bottom paint, anti-fouling  
Bow pole & burgee  
Bow pulpit, w/rail  
Chocks, p & s  
Coaming, cockpit, padded vinyl  
Cockpit, fiberglass  
Command Bridge<sup>®</sup> including:  
  Engine instrumentation  
  tachometer, water temperature, oil pressure, voltmeter, alarms, transmission  
  Hour meters  
  4" lighted compass  
  Rails, stainless steel  
  Seat, forward facing w/cushion  
  Seat, helm (2)  
Windscreen  
Covering boards, teak, aft  
Pole & flag, stern  
Privacy cover, windshield  
Transom door  
Trim tabs  
Windows, cabin side, sliding w/screens

**Electrical:**

Rectifier, 20 amps, auto charge (2) & disconnect  
Wiring, dockside, (1) 115V AC 30 amp inlet, starboard, including (1) 50' ship to shore cable & cabin outlets, circuit breaker panel  
Generator: 12 kw, diesel, fresh water cooled, remote start station, indicator light w/sound shield, muffler, fuel filter, or Onan 6½ kw standard w/gas

**Interior:**

Bed, double, w/spread, master stateroom  
Berths, w/mattress & spreads, guest stateroom  
Blower, exhaust, head  
Draperies, except windshield  
Glass, tinted, deckhouse  
Lights, throughout, 12V  
Lockers  
Mirrors  
Refrigerator, 15 cu.ft., 2-door, w/freezer & automatic icemaker  
Screens, cabin window, p & s  
Shower, w/removable head & flex tube, sump pump, light  
Sink, lavatory  
Sink, stainless steel, galley  
Teak parquet floor, galley & head  
Toilet, electric, w/dockside discharge & holding tank  
Wardrobes, staterooms